

PREDATOR 62

STYLE: PERFORMANCE MOTORYACHT

ACCOMMODATION: UP TO 6 GUESTS AND 1 CREW MEMBER

PERFORMANCE: UP TO 37 KNOTS

FOR FRIENDS AND FAMILY THE PREDATOR 62 PRESENTS A POWERFUL HOLIDAY PLATFORM. WITH A CRUISING RANGE OF 270 NAUTICAL MILES THERE'S SCOPE TO ENJOY A GREAT DEAL. AND AT FULL PELT, 37 KNOTS GETS YOU WHEREVER – FAST. WHILE THE RIDE THRILLS, THE SUNSEEKER HULL DESIGN AND DECK DETAILING PROVIDES AN IMPRESSIVE SOFT RIDING SENSATION. MOVEMENT AROUND IS MADE EASY WITH GOOD SIZE SIDE DECKS AND HANDRAILS EXACTLY WHERE NEEDED. BEYOND DESIGN STUDY THE COMFORT IS IN THE PLAN, WITH THIS PREDATOR CONTINUING THE THEME OF OPEN PLAN DECK SALOON WITH ATRIUM STYLE STAIRWELL, THIS TIME TO A SECOND LOWER SALOON AND GALLEY FROM WHICH THREE SLEEPING CABINS RADIATE.



Main deck

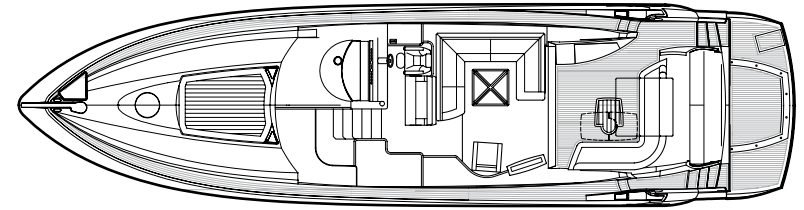

Lower deck with optional crew cabin in lieu of garage

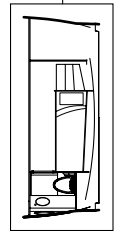
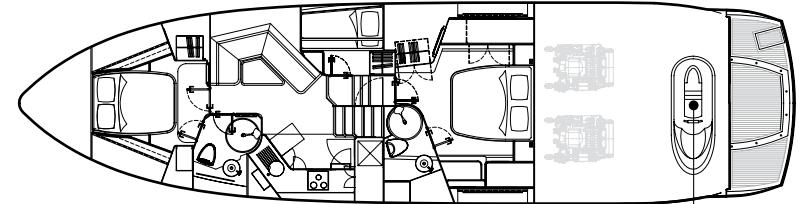

PRINCIPAL CHARACTERISTICS

Length overall – (incl. pulpit & platform)	19.60m	64'4"
Length hull – (incl. platform)	19.10m	62'8"
Length waterline – (@ half load)	14.67m	48'2"
Beam – (maximum)	5.00m	16'5"
Draft – (maximum incl. stern gear)	1.54m	5'1"
Displacement – (@ half load)	29000kg	63800lb
Fuel capacity	3000 litres	660 GB gal. 792 US gal.
Fresh-water capacity	700 litres	154 GB gal. 185 US gal.
Propulsion	Twin submerged props in semi-tunnels	
Engine options	up to 2200 PS (total)	

Fuel options	Diesel
Generators	Standard 9kW @ 50Hz (Euro) 15.5kW @ 60Hz (US) Upgrade 13kW @ 50Hz (Euro)
Maximum speed	up to 37 knots*
Cruising speed	up to 28 knots*
Range	up to 270 nautical miles*

All principal characteristics and specifications are provisional.



PREDATOR 62

PRINCIPAL FEATURES

Electric winch with deck and cockpit controls
Hot and cold swimming shower
Swimming ladder
Full wetbar with ice maker, griddle, cool box and sink with hot and cold water
Foot level courtesy lighting
Radar, autopilot, electronic speedlog depth sounder, and VHF radio
Hydraulic power steering
Trim tabs
Stainless steel sliding doors to cockpit
Flatscreen televisions in all cabins
Hi-fi DVD/CD surround system
CD player for cockpit
Ceramic hob
Electric refrigerator and freezer
Microwave/grill
Vacuum toilets and holding tank
Hot and cold water system
Automatic fire extinguishers
Automatic bilge pumps
AC shorepower/battery charger
Slow speed generator with underwater silent exhaust
Fresh-water marina connection
Teak bathing platform and steps
Hydraulic lifting platform
Antifouling

All items included in standard specification.

US specification includes:

Air-conditioning
Upgraded generator
US Coast Guard build regulations
US specification appliances

Optional extras:

Air-conditioning
Upgraded generator
Teak cockpit
Teak deck saloon
Bow thruster
Single berth crew cabin with toilet

STANDARD SPECIFICATIONS

1 Construction

Hand-laid GRP
Gel coat including stripes
Vinylester skin coat with powderbound mat
Stitched multi-axial reinforced single skin bottom
Balsa cored hull topsides
PVC foam cored deck and superstructure
Hull stiffened with longitudinal stringers supported by transverse bulkheads and floors

2 Deck

Fittings all in stainless steel
8 x stainless steel deck cleats
Pulpit and cockpit rails
Stainless steel fendering with rubber insert
Curved safety glass windscreen
Stainless steel bow roller with anchor stop
Stainless steel bow plate
Delta anchor and 45m chain (galvanised)
Electric winch and capstan with deck and cockpit controls
Chain locker – fender stowage
Fender tie bar under anchor locker lid
Fuel fillers port and starboard
Fresh-water filler
IMCO navigation lights
2 x Pantograph windscreen wipers and washers
Garage for jet-ski (not available with crew cabin option)
Ensign staff and socket

3 Bathing platform

Teak-laid bathing platform and steps
Hot and cold swimming shower
Fresh-water marina connection
Dockside AC shore power connection
Stainless steel swimming ladder
Hydraulic lifting platform

4 Aft cockpit

Self draining
Stern safety door
Cockpit speakers
Wetbar sink with hot and cold water, cool box, ice maker, bottle locker and griddle
Upholstered seating around cockpit table
Convertible sunbather
Lockers beneath seating
Cockpit carpet
Overhead cockpit lights 24v
Low-level courtesy lights 24v
Engine room access hatch
Boat hook

5 Helm console

Double stand/sit helm and co-pilot seat
Storage beneath co-pilot seats
Chart area
Console with burr type walnut fascia
Hydraulic power steering
Wooden rimmed steering wheel
Full analogue engine instrumentation
Radar open scanner
Autopilot
Electronic speed log
Depth sounder
Rudder indicator
Water tank gauge
Fuel tank gauge
VHF radio
Trim tab controls
Single lever engine controls
Compass
Waterproof plug and socket
Horn
Windscreen wipers and washers
Glass holders
Hand-held fire extinguisher

6 Deck saloon

Large dining area with folding table
Stowage beneath seats
Flatscreen television
DVD/CD hi-fi surround system
Cupboards
Carpet
Overhead halogen lighting 24v
Stainless steel sliding door to cockpit
Main control panel (AC/DC)
Generator controls
Double AC socket
Hand-held fire extinguisher
Scatter cushions
Choice of lacquered interior finishes and veneers

7 Galley

Sink and drainer
2-ring ceramic hob
Electric refrigerator
Electric freezer
Microwave/grill
Rubbish bin
Cupboard and drawer storage
Drinks cupboard
6 place crockery set
6 place cutlery set
Double AC socket
Hand-held fire extinguisher
First aid kit

1. Master stateroom
2. The Predator 62 at anchor
3. The Predator 62
4. Upper saloon and drive station
5. Saloon seating
6. Relaxing on the foredeck
7. Hydraulic bathing platform
8. En suite shower room



8 Forward stateroom

Double berth
Storage beneath
Drawer in base end
2 x reading lights 24v
Outboard shelving
Overhead bedside cupboards
Hanging wardrobe with mirrored door
Shelved cupboard
Halogen overhead lights 24v
2 x opening portholes with mosquito screens and curtains
Deck hatch with mosquito screen
Double AC socket
Door to shower room
Fitted carpet
Flatscreen television

9 Forward en suite shower room

Washbasin
Taps and accessories
Separate shower compartment
Vacuum toilet
Extractor fan
Mirrored vanity unit
Shelved cupboard
Toothbrush and glass holder
Towel ring and towels
Overhead light
Opening porthole with mosquito screen and blind
Shaver socket 240/110v
Soap dish

10 Lower saloon

Dining area with table
Stowage beneath seats
Overhead cupboards
Opening portholes with mosquito screen and curtains
Halogen overhead lighting 24v
Double AC socket
Hand-held fire extinguisher
Fitted carpet
Scatter cushions
Flatscreen television

11 Master aft stateroom

Double berth
Cupboard and draw stowage
2 x reading lights 24v
Outboard shelving
Bedside drawers
Wardrobe
Halogen overhead lights 24v
2 x large opening and 4 x fixed portholes with mosquito screens and curtains
Double AC socket
Door to shower room
Fitted carpet
Flatscreen television

12 Aft en suite shower room

Washbasin
Taps and accessories
Separate shower compartment
Vacuum toilet
Extractor fan
Mirrored vanity unit
Shelved cupboard
Toothbrush and glass holder
Towel ring and towels
Overhead light
Opening porthole with mosquito screen and blind
Shaver socket 240/110v
Soap dish

13 Engine compartment and ancillaries

Twin engines
Soundproofing throughout engine room
1 x fuel tank with electric sending unit
Separate fuel filters/water separators
Automatic fire extinguishers
Engine room and forward bilge flood alarms
2 x automatic bilge pumps
2 x automatic flood pumps
4 x extractor fans 24v
Manual bilge pump

14 Electrical system

Slow speed generator with underwater silent exhaust and sound shield
AC dockside connection
Galvanic isolator
24v and 12v DC electrical system with full circuit breaker protection
6 x engine batteries 24v circuit
4 x domestic batteries 24v circuit
2 x generator batteries 12v circuit
Alternator split charging system
Remote battery switches controlled from locker in cockpit
Battery charger for 24v circuits
Battery charger for 12v circuits
Water heater
AC sockets through out the boat
24v hand light and cable

15 Underwater gear

Direct shaft drive through half tunnels
4-blade NAB bronze propellers
Bronze P-brackets
Stainless steel Temet 25 shafts
Dripless shaft logs with spare seal
High-performance bronze rudders and struts
Seawater strainers – 2 x main engines/1 x generators
Seacocks on all underwater fittings
Full cathodic bonding system to zinc anodes
Stainless steel hydraulic trim tabs 24v

16 Systems

Hydraulic power steering engine driven pump
24v hydraulic power pack for trim tabs and platform
24v hydraulic power pack for gangway
Aluminium fresh-water tank with electric sending unit
24v fresh-water pressure system
Hot water tank

17 Miscellaneous

Toolkit
Boat hook
4 x mooring ropes
6 x fenders
Spare bulbs and fuses
2 sets towels

18 Optional extras

Air-conditioning
Upgraded generator
Teak cockpit
Teak deck saloon
Bow thruster
Single berth crew cabin with toilet

US specification includes

Air-conditioning
Upgraded generator
US Coast Guard build regulations
US specification appliances



*Every attempt has been made to give accurate information, but performance and range figures are estimates given as a guide only. Dirt or growth on the hull, tuning of the engines, size, make of engines fitted, damage to propellers, the temperature of the air and water, the weight of fuel, water, stores, number of people, propeller pitch, quality of fuel and other matters, can all affect a boat's performance and range. For these and other reasons we can give no performance, range or other guarantees, and neither such guarantees nor anything contained herein constitutes an offer of contract or any representation or agreement, or may otherwise be relied upon. The photographs and artist's impressions in this brochure are of existing models in the Sunseeker range. There may be items shown in these photographs and artist's impressions that are not included in the standard inventory of the models shown. Specifications contained on the web site are samples only and should not be relied upon and may refer to models only intended for sale in a particular territory and not generally. No guarantee is given that any model will be available in any territory; however by contacting us we can advise you of models that are likely to be available in each territory. Actual specifications will be provided when a sales order or enquiry is placed with us or our approved Sunseeker dealer.

Specifications for models sold in different markets may vary and specifications and models may be changed or withdrawn at any time without prior notice. The individual specification for each vessel will be agreed as part of the sale contract between the purchaser and the Sunseeker dealer. Dealers and distributors are independently owned and operated entities, and therefore Sunseeker dealers and distributors are not owned by Sunseeker International Limited or any subsidiaries or other related entity of this company nor are they their agents. Therefore they have absolutely no authority to commit Sunseeker International Limited, or any subsidiary or other related entities of Sunseeker International Limited to any pledge, contract or agreement in any form or by any means unless first accepted in writing by Sunseeker International Limited. In some examples herein Sunseeker have referred to measurements, specifications or other details applicable to a particular territory and no guarantee is given that these are applicable to your territory. For ease of reference we have, in some cases, referred to "we" or "Sunseeker" and these terms should be taken to mean Sunseeker International Limited.



Awards

Sunseeker's success over the years is clearly underlined by the following list of national and international awards and achievements.

2008	UK Motor Boat of the Year Awards 2008	Manhattan 60	2001	Best Power Interior Award	105 Yacht, The Superyacht Society
2007	European Powerboat of the Year	Superhawk 43	2001	President's Award	Southern California Marine Association
2007	Asia Pacific Boating Awards	90 Yacht, Best of the Best	2000	Queen's Award for Enterprise	Continuous innovation and development
2007	Modern Boating Magazine 2007	Portofino 47, Imported Powerboat of the Year	2000	The Times Exporter of the Year	Times Export Awards
2007	Australian Marine Industries Federation Awards	Predator 62, Imported Powerboat of the Year	2000	Robb Report Award	Best of the Best, Boating and Sailing
2007	Nominated by The Superyacht Society	37 Metre Yacht 'The Snapper'	1999	Robb Report Award	Best of the Best, Boating and Sailing
2007	Queen's Award for Enterprise	International Trade	1999	Motorboat of the Year	Predator 75, BT British Nautical Awards
2006	Nominated for three Superyacht Awards	Predator 108 'SHIVER'	1998	Superyacht Design Award	Manhattan 74, Superyacht Design Awards
2005	Australian Marine Industries Federation Awards	75 Yacht, Non-Trailable Boat Award	1998	Editor in Chief Awards	Yachts Magazine
2005	Australian Marine Industries Federation Awards	Portofino 46, Commendation	1997	Lifetime Achievement Award	Robert Braithwaite MBE, RYA Awards
2005	Modern Boating, Power Boat of the Year Awards	Predator 68, Imported Powerboat of the Year	1996	Motorcruiser of the Year Award	RYA British Nautical Awards
2005	Boats.com Marine Industry Web Awards	Manufacturers Category for www.sunseeker.com	1996	Exporter of the Year Award	DCCI Export Awards
2004	Sydney Boat Show 2004	Best Overall Display	1995	Boat Builder of the Year Award	RYA/BMIF British Nautical Awards
2004	Sydney Boat Show 2004	Best Marina Display	1994	Queen's Award for Export Achievement	Queen's Awards for Industry
2003	Australian Marine Awards	Manhattan 56, Award for Excellence	1992	Best in the World Award	Renegade 60, Boating Magazine
2003	Australian Marine Awards	Predator 68, Best Imported Non-Trailable Yacht	1990	Exporter of the Year	SW International Business Awards
2002	Entrepreneur of the Year Award	Robert Braithwaite MBE	1989	Queen's Award for Export Achievement	Queen's Awards for Industry
2001	Best Power Design Award	105 Yacht, The Superyacht Society	1987	Queen's Award for Export Achievement	Queen's Awards for Industry

Naval architects

Don Shead/Sunseeker Design

Exterior styling

Sunseeker Design

Interior design

Sunseeker Design

Builder

Sunseeker International

*Every attempt has been made to give accurate information, but performance and range figures are estimates given as a guide only. Dirt or growth on the hull, tuning of the engines, size, make of engines fitted, damage to propellers, the temperature of the air and water, the weight of fuel, water, stores, number of people, propeller pitch, quality of fuel and other matters, can all affect a boat's performance and range. For these and other reasons we can give no performance, range or other guarantees, and neither such guarantees nor anything contained herein constitutes an offer of contract or any representation or agreement, or may otherwise be relied upon. The photographs and artist's impressions in this brochure are of existing models in the Sunseeker range. There may be items shown in these photographs and artist's impressions that are not included in the standard inventory of the models shown. Specifications contained on the web site are samples only and should not be relied upon and may refer to models only intended for sale in a particular territory and not generally. No guarantee is given that any model will be available in any territory; however by contacting us we can advise you of models that are likely to be available in each territory. Actual specifications will be provided when a sales order or enquiry is placed with us or our approved Sunseeker dealer. Specifications for models sold in different markets may vary and specifications and models may be changed or withdrawn at any time without prior notice. The individual specification for each vessel will be agreed as part of the sale contract between the purchaser and the Sunseeker dealer. Dealers and distributors are independently owned and operated entities, and therefore Sunseeker dealers and distributors are not owned by Sunseeker International Limited or any subsidiaries or other related entity of this company nor are they their agents. Therefore they have absolutely no authority to commit Sunseeker International Limited, or any subsidiary or other related entities of Sunseeker International Limited to any pledge, contract or agreement in any form or by any means unless first accepted in writing by Sunseeker International Limited. In some examples herein Sunseeker have referred to measurements, specifications or other details applicable to a particular territory and no guarantee is given that these are applicable to your territory. For ease of reference we have, in some cases, referred to "we" or "Sunseeker" and these terms should be taken to mean Sunseeker International Limited.

Designed, written and produced by Marketing Matters Limited. Printed in England. August 2008. ©Sunseeker International.



Sunseeker International Limited has CE Approval which is compulsory for all boats with a LOA of 24m and below when sold in the EU.