

# PORTOFINO 47

**STYLE:** SPORTS CRUISER

**ACCOMMODATION:** UP TO 4 GUESTS

**PERFORMANCE:** UP TO 34 KNOTS

BRINGING THE BIG-BODIED AND OUTDOOR-LIFE PORTOFINO THEME BANG UP TO DATE, THE PORTOFINO 47 CAN BE SPECIFIED EITHER AS AN OPEN COCKPIT CRAFT OR TOPPED WITH THE STYLISTIC SLIDING HARD TOP AS OF THE BIGGER PORTOFINO 53. THE NEW DETAILING ALSO INTRODUCES THE SUBMERGING BATHING PLATFORM WHICH DOUBLES AS SLIP FOR THE TENDER. THE ACCOMMODATION BELOW REVOLVES AROUND A LARGE SALOON AND WELL-EQUIPPED GALLEY WITH A MASTER STATEROOM FORWARD AND A TWIN BED CABIN AFT, BOTH EN SUITE. THE COCKPIT ABOVE INCORPORATES COMPANIONABLE SEATING FORWARD ADJACENT TO THE HELM STATION WITH A SECOND SOCIAL AREA AFT WITH SEATING, WETBAR AND SUNPAD.

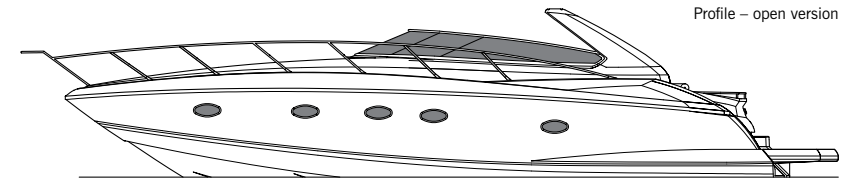

Profile – open version

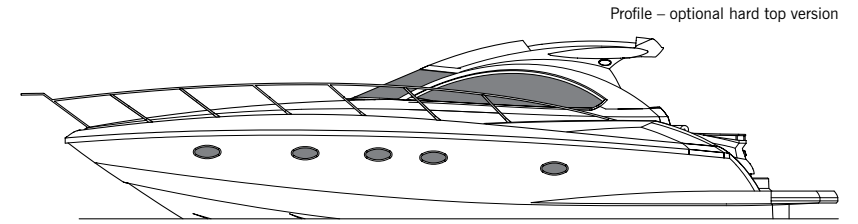

Profile – optional hard top version

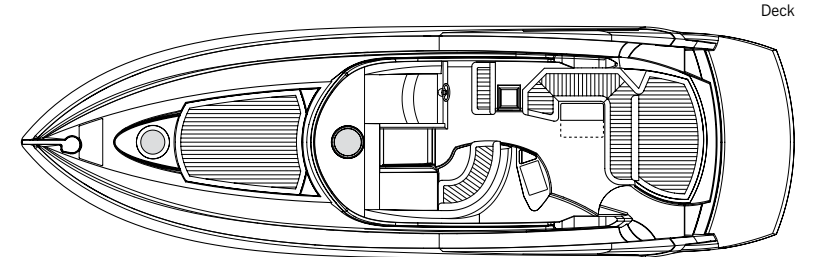

Deck

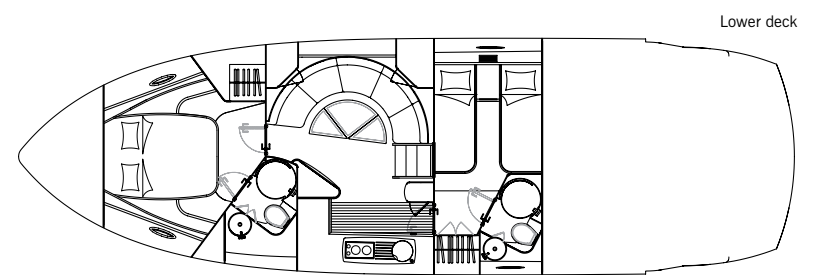

Lower deck

## PRINCIPAL CHARACTERISTICS

<b>Length overall – (incl. pulpit)</b>	14.95m	49'1"
<b>Length hull – (incl. platform)</b>	14.18m	46'6"
<b>Length waterline – (@ half load)</b>	10.90m	35'9"
<b>Beam – (maximum)</b>	4.30m	14'1"
<b>Height above waterline – (excl. navigation mast)</b>	4.10m	13'5"
<b>Draft – (maximum @ full load)</b>	1.20m	3'11"
<b>Displacement – (@ half load)</b>	16400kg	36146lb
<b>Fuel capacity</b>	1310 litres	288 GB gal. 346 US gal.
<b>Fresh-water capacity</b>	340 litres	75 GB gal. 90 US gal.
<b>Propulsion</b>	Twin FP props in tunnels/IPS	

<b>Engine options</b>	up to 1150 PS (total)
<b>Fuel options</b>	Diesel
<b>Generators</b>	Standard 4kW @ 50Hz (Euro) 9kW @ 60Hz (US) Upgrade 7kW @ 50Hz (Euro)
<b>Maximum speed</b>	up to 34 knots*
<b>Cruising speed</b>	up to 22 knots*
<b>Range</b>	up to 200 nautical miles*

All principal characteristics and specifications are provisional.





# PORTOFINO 47

## PRINCIPAL FEATURES

Lifting platform  
Electric anchor winch with deck and cockpit controls  
Hot and cold swimming shower  
Full wetbar with hot and cold water  
Coolbox  
Large cockpit table  
Depth sounder  
VHF radio  
Flatscreen television in all cabins  
DVD player in saloon  
Radio/CD  
Electric refrigerator  
Electric hob and microwave  
Hot and cold water system  
Automatic fire extinguishers  
Automatic bilge pump  
Radar  
Autopilot  
Generator  
Teak bathing platform and step  
AC shorepower/battery charger  
Vacuum toilets and holding tank

All items included in standard specification.

US specification includes:

Air-conditioning  
Upgraded generator  
US Coast Guard build regulations  
US specification appliances

## STANDARD SPECIFICATIONS

### 1 Construction

Hand-laid GRP  
Gel coat including stripes  
Vinylester skin coat with powderbound mat  
Stitched multi-axial reinforced single skin bottom  
Balsa cored hull topsides  
PVC foam cored deck and superstructure  
Hull stiffened with longitudinal stringers supported by transverse bulkheads and floors

### 2 Deck

Moulded non-slip deck finish  
Fittings all in stainless steel  
Pulpit and cockpit rails  
Stainless steel fendering with rubber insert  
10 stainless steel cleats  
Curved stainless steel framed windscreen on open version.  
Electric anchor winch and capstan with deck and cockpit controls  
Stainless steel bow roller with anchor stop  
Delta anchor and 30m chain (galvanised)  
Chain locker with fender storage  
IMCO navigation lights  
Fuel filler  
Fresh-water filler  
Foldaway swimming ladder  
Teak-laid bathing platform and steps  
Hydraulic lifting platform  
Hot and cold swimming shower  
Ensign staff and socket  
Fender tie bar under anchor locker lid

### 3 Cockpit

Self draining  
Safety door  
Full wetbar with hot and cold water, cool box  
Dinette seating  
Fold-out table  
Storage beneath seating  
Folding helm seat  
Curved co-pilot seating area  
Chart table  
Sunbather  
Large storage locker under sunbather  
Glass holders  
Overhead cockpit lights 12v  
Low-level cockpit lights  
Waterproof carpet

### 4 Helm console

Contoured console with burr type walnut fascia  
Radar  
Autopilot  
VHF radio  
Wood rimmed steering wheel  
Single lever controls  
Full analogue engine instrumentation  
Electronic speedlog  
Depth sounder  
Fuel gauge  
Fresh-water gauge  
Compass  
Horn  
Trim tab controls  
Waterproof plug and socket  
2 windscreen wipers and washers  
Fire extinguisher  
Glass holders

### 5 Main cabin/saloon

Large dinette  
Flatscreen television  
DVD player  
Radio/CD with speakers in cabin and cockpit  
Stowage beneath seats and table  
Scatter cushions  
Drinks cupboard  
Overhead halogen lights 12v  
Opening portholes with mosquito screens and curtains  
Deck hatch  
Main switch and circuit breaker panel (AC/DC)  
Double AC socket  
Choice of lacquered interior finishes and veneers  
Fitted carpet

### 6 Galley

Electric refrigerator  
Electric twin hob  
Microwave  
6 place crockery set  
6 place cutlery set  
Cupboard storage and drawers  
Opening porthole with mosquito screen and blind  
Double AC socket  
Hand-held fire extinguisher  
First aid kit  
Rubbish bin

1. The upper deck and helm
2. The Portofino 47
3. The Portofino 47 cruising with tender on board
4. Main saloon dining area
5. The Portofino 47 cruising
6. Enjoying the view from the large cockpit windows
7. Aft bathing platform with tender
8. Forward cabin



## 7 Master stateroom

Double bed  
Storage beneath  
Drawers in bed end  
2 reading lights 12v  
Hanging wardrobe  
Overhead halogen lighting  
2 x opening portholes with mosquito screen and curtains  
Deck hatch  
Door to toilet/shower  
Double AC socket  
Flatscreen television  
Fitted carpet

## 8 Master en suite toilet and bathroom

Wash basin  
Taps and accessories  
Mirrored vanity unit  
Toothbrush glass holder  
Soap dish  
Towel ring  
Stowage cupboard  
Vacuum toilet  
Shower compartment  
Overhead lights  
Opening porthole with mosquito screen and curtain  
Razor socket 240/110v

## 9 Twin aft cabin

Two single berths  
Under-berth storage and drawers  
Hanging wardrobe  
Storage cupboard  
Overhead halogen lighting  
2 reading lights  
Opening porthole with mosquito screen  
Double AC socket  
Flatscreen television  
Fitted carpet

## 10 En suite toilet compartment

Wash basin  
Taps and accessories  
Mirrored vanity unit  
Toothbrush glass holder  
Soap dish  
Towel ring  
Shower  
Overhead lights  
Vacuum toilet  
Opening porthole with mosquito screen and curtain  
Razor socket 240/110v

## 11 Engine compartment and ancillaries

Twin engines with close coupled V-drive gearbox  
Sound insulation throughout engine room  
2 x aluminium fuel tanks with electric senders  
Automatic fire extinguishers  
Automatic bilge pump  
Separate fuel filters/water separators  
Extractor fans  
Aluminium fresh-water tank with electric sender  
Fresh-water pressure system  
Hot water tank

## 12 Electrical system

Slow speed generator with underwater silent exhaust system  
AC dockside connection  
Galvanic isolator  
24v DC electrical system with full circuit breaker protection  
4 x engine batteries  
4 x domestic batteries  
2 x generator batteries  
Alternator split charging system  
Battery switches controlled from locker in cockpit  
Battery charger  
Water heater  
AC sockets throughout the boat

## 13 Underwater gear

Direct shaft drive through half tunnels  
4-blade NAB bronze propellers  
Bronze P-brackets  
2 x 2" stainless steel Temet 25 shafts  
Dripless shaft logs with spare seals  
High-performance bronze rudders and struts  
Seawater strainers x 2 main engines 1 generator  
Seacocks on all underwater fittings  
Full cathodic bonding system to zinc anodes  
Stainless steel hydraulic trim tabs 24v

## 14 Miscellaneous

2 sets towels  
2 x mooring warps  
6 x fenders

## 15 Optional extras

Opening hard top  
Air-Conditioning  
Upgraded generator  
Teak cockpit  
Bow thruster

## US specification includes:

Air-conditioning  
Upgraded generator  
US Coast Guard build regulations  
US specification appliances



\*Every attempt has been made to give accurate information, but performance and range figures are estimates given as a guide only. Dirt or growth on the hull, tuning of the engines, size, make of engines fitted, damage to propellers, the temperature of the air and water, the weight of fuel, water, stores, number of people, propeller pitch, quality of fuel and other matters, can all affect a boat's performance and range. For these and other reasons we can give no performance, range or other guarantees, and neither such guarantees nor anything contained herein constitutes an offer of contract or any representation or agreement, or may otherwise be relied upon. The photographs and artist's impressions in this brochure are of existing models in the Sunseeker range. There may be items shown in these photographs and artist's impressions that are not included in the standard inventory of the models shown. Specifications contained on the web site are samples only and should not be relied upon and may refer to models only intended for sale in a particular territory and not generally. No guarantee is given that any model will be available in any territory; however by contacting us we can advise you of models that are likely to be available in each territory.

Actual specifications will be provided when a sales order or enquiry is placed with us or our approved Sunseeker dealer. Specifications for models sold in different markets may vary and specifications and models may be changed or withdrawn at any time without prior notice. The individual specification for each vessel will be agreed as part of the sale contract between the purchaser and the Sunseeker dealer. Dealers and distributors are independently owned and operated entities, and therefore Sunseeker dealers and distributors are not owned by Sunseeker International Limited or any subsidiaries or other related entity of this company nor are they their agents. Therefore they have absolutely no authority to commit Sunseeker International Limited, or any subsidiary or other related entities of Sunseeker International Limited to any pledge, contract or agreement in any form or by any means unless first accepted in writing by Sunseeker International Limited. In some examples herein Sunseeker have referred to measurements, specifications or other details applicable to a particular territory and no guarantee is given that these are applicable to your territory. For ease of reference we have, in some cases, referred to "we" or "Sunseeker" and these terms should be taken to mean Sunseeker International Limited.



## Awards

Sunseeker's success over the years is clearly underlined by the following list of national and international awards and achievements.

2008	UK Motor Boat of the Year Awards 2008	Manhattan 60	2001	Best Power Interior Award	105 Yacht, The Superyacht Society
2007	European Powerboat of the Year	Superhawk 43	2001	President's Award	Southern California Marine Association
2007	Asia Pacific Boating Awards	90 Yacht, Best of the Best	2000	Queen's Award for Enterprise	Continuous innovation and development
2007	Modern Boating Magazine 2007	Portofino 47, Imported Powerboat of the Year	2000	The Times Exporter of the Year	Times Export Awards
2007	Australian Marine Industries Federation Awards	Predator 62, Imported Powerboat of the Year	2000	Robb Report Award	Best of the Best, Boating and Sailing
2007	Nominated by The Superyacht Society	37 Metre Yacht 'The Snapper'	1999	Robb Report Award	Best of the Best, Boating and Sailing
2007	Queen's Award for Enterprise	International Trade	1999	Motorboat of the Year	Predator 75, BT British Nautical Awards
2006	Nominated for three Superyacht Awards	Predator 108 'SHIVER'	1998	Superyacht Design Award	Manhattan 74, Superyacht Design Awards
2005	Australian Marine Industries Federation Awards	75 Yacht, Non-Trailable Boat Award	1998	Editor in Chief Awards	Yachts Magazine
2005	Australian Marine Industries Federation Awards	Portofino 46, Commendation	1997	Lifetime Achievement Award	Robert Braithwaite MBE, RYA Awards
2005	Modern Boating, Power Boat of the Year Awards	Predator 68, Imported Powerboat of the Year	1996	Motorcruiser of the Year Award	RYA British Nautical Awards
2005	Boats.com Marine Industry Web Awards	Manufacturers Category for www.sunseeker.com	1996	Exporter of the Year Award	DCCI Export Awards
2004	Sydney Boat Show 2004	Best Overall Display	1995	Boat Builder of the Year Award	RYA/BMIF British Nautical Awards
2004	Sydney Boat Show 2004	Best Marina Display	1994	Queen's Award for Export Achievement	Queen's Awards for Industry
2003	Australian Marine Awards	Manhattan 56, Award for Excellence	1992	Best in the World Award	Renegade 60, Boating Magazine
2003	Australian Marine Awards	Predator 68, Best Imported Non-Trailable Yacht	1990	Exporter of the Year	SW International Business Awards
2002	Entrepreneur of the Year Award	Robert Braithwaite MBE	1989	Queen's Award for Export Achievement	Queen's Awards for Industry
2001	Best Power Design Award	105 Yacht, The Superyacht Society	1987	Queen's Award for Export Achievement	Queen's Awards for Industry

### Naval architects

Don Shead/Sunseeker Design

### Exterior styling

Sunseeker Design

### Interior design

Sunseeker Design

### Builder

Sunseeker International

\*Every attempt has been made to give accurate information, but performance and range figures are estimates given as a guide only. Dirt or growth on the hull, tuning of the engines, size, make of engines fitted, damage to propellers, the temperature of the air and water, the weight of fuel, water, stores, number of people, propeller pitch, quality of fuel and other matters, can all affect a boat's performance and range. For these and other reasons we can give no performance, range or other guarantees, and neither such guarantees nor anything contained herein constitutes an offer of contract or any representation or agreement, or may otherwise be relied upon. The photographs and artist's impressions in this brochure are of existing models in the Sunseeker range. There may be items shown in these photographs and artist's impressions that are not included in the standard inventory of the models shown. Specifications contained on the web site are samples only and should not be relied upon and may refer to models only intended for sale in a particular territory and not generally. No guarantee is given that any model will be available in any territory; however by contacting us we can advise you of models that are likely to be available in each territory. Actual specifications will be provided when a sales order or enquiry is placed with us or our approved Sunseeker dealer. Specifications for models sold in different markets may vary and specifications and models may be changed or withdrawn at any time without prior notice. The individual specification for each vessel will be agreed as part of the sale contract between the purchaser and the Sunseeker dealer. Dealers and distributors are independently owned and operated entities, and therefore Sunseeker dealers and distributors are not owned by Sunseeker International Limited or any subsidiaries or other related entity of this company nor are they their agents. Therefore they have absolutely no authority to commit Sunseeker International Limited, or any subsidiary or other related entities of Sunseeker International Limited to any pledge, contract or agreement in any form or by any means unless first accepted in writing by Sunseeker International Limited. In some examples herein Sunseeker have referred to measurements, specifications or other details applicable to a particular territory and no guarantee is given that these are applicable to your territory. For ease of reference we have, in some cases, referred to "we" or "Sunseeker" and these terms should be taken to mean Sunseeker International Limited.

Designed, written and produced by Marketing Matters Limited. Printed in England. August 2008. ©Sunseeker International.



Sunseeker International Limited has CE Approval which is compulsory for all boats with a LOA of 24m and below when sold in the EU.