

# 70



## MANHATTAN 70

SPECIFICATION



---

The latest addition to this exceptional flybridge range, the Manhattan 70 sets the standard for high-level entertainment, putting the emphasis on fun and excitement in Sunseeker's inimitable style. Effortlessly blending luxury with practicality, the Manhattan 70 has a broad beam, graceful profile and extended cruising capabilities. En suite accommodation for eight and self-contained aft crew quarters make the Manhattan 70 a highly versatile vessel.

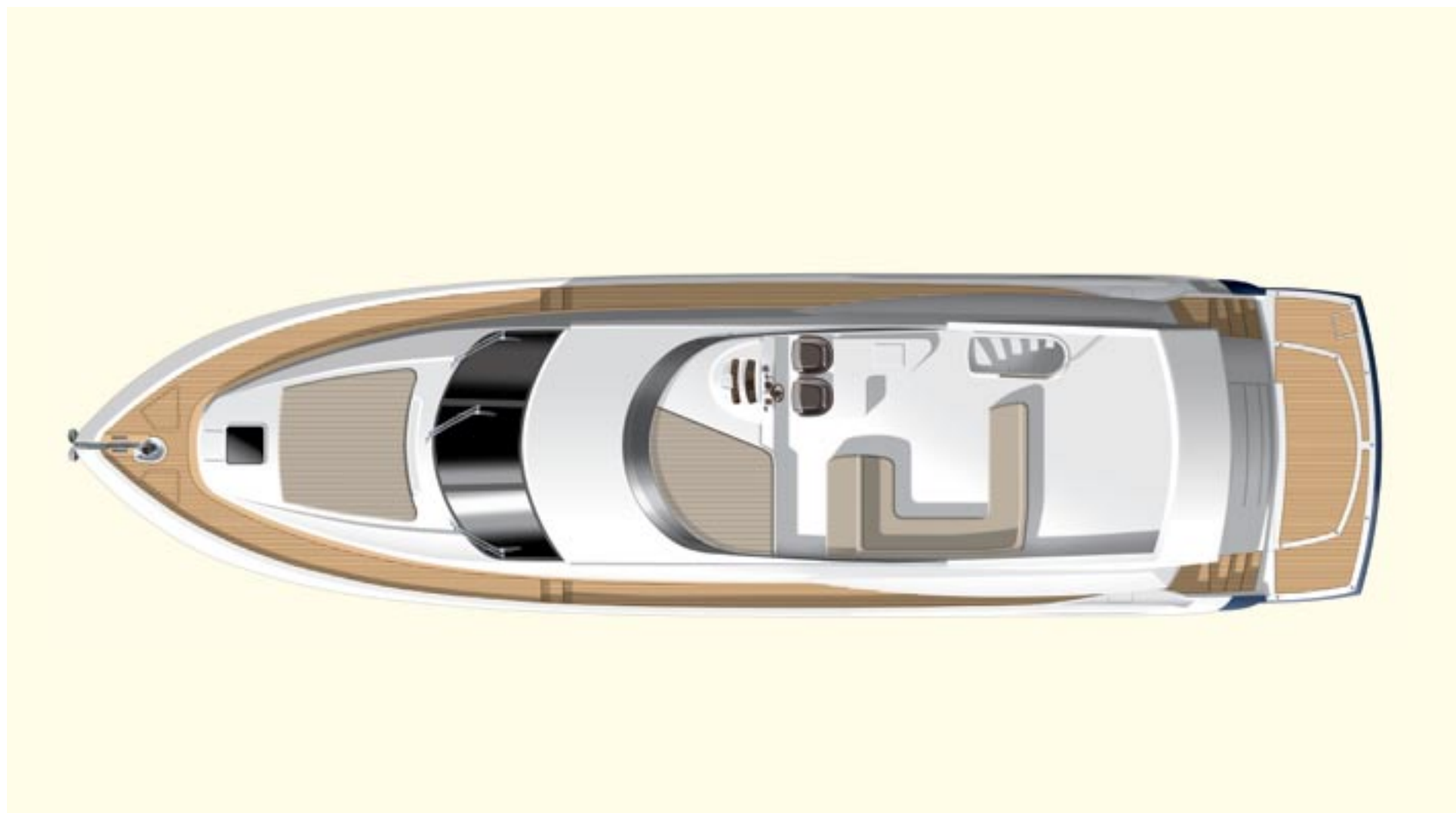

PRINCIPAL CHARACTERISTICS – Provisional

Length overall – (incl. pulpit and platform)	22.28m	73'1"	
Length hull – (incl. platform)	21.38m	70'2"	
Length waterline – (@ half load)	16.65m	54'7"	
Beam – (maximum incl. rubbing strake)	5.67m	18'7"	
Maximum draft – (@ full load displacement)	1.62m	5'4"	
Displacement – (@ half load)	41200kg	135170 lb	
Fuel capacity	4650 litres	1023 GB gal.	1229 US gal.
Fresh water capacity	1200 litres	264 GB gal.	317 US gal.
Propulsion	Twin prop		
Engine options	up to 3100 PS (total)		
Fuel options	Diesel		
Generators	Standard		
	20kW @ 50Hz (Euro)		
	23kW @ 60Hz (US)		
	Upgrade		
	23kW + 17kW @ 50Hz (Euro)		
	28kW + 20kW @ 60Hz (US)		
Maximum speed	up to 36 knots*		
Cruising speed	up to 25 knots*		
Range	up to 300 nautical miles*		

All principal characteristics and specifications are provisional

PRINCIPAL FEATURES – Provisional

Hydraulic lifting platform  
Electric winch with deck, cockpit and flybridge controls  
Side opening helm access door  
Hot and cold swimming shower  
Electronic echo sounder and speedlog  
Power-assisted steering  
Wetbar with hot and cold water  
Ice maker  
Flatscreen televisions in all cabins  
DVD cinema surround system  
Hot and cold water system  
Electric refrigerator and freezer  
Ceramic hob and microwave/grill  
Radar/Chart plotter with GPS  
Autopilot  
VHF radio  
Trim tabs  
Vacuum toilets with holding tank  
Air conditioning  
Automatic fire extinguishers  
Automatic bilge pumps  
Slow speed generator with silent exhaust  
AC shorepower/battery charger  
Bow thruster  
Fresh water marina connection  
Teak bathing platform and steps  
Teak cockpit floor  
Stern winches  
Antifouling

All items included in standard specification.

US specification includes:  
US Coast Guard build regulations  
US specification appliances

Optional Extras:  
Passerelle  
Teak flybridge  
Teak side decks

STANDARD SPECIFICATIONS – Provisional

- 1 Construction**  
Hand-laid GRP  
Gel coat including stripes  
Vinylester skin coat with powderbound mat  
Stitched multi-axial reinforced single skin bottom  
Balsa cored hull topsides  
PVC foam cored deck and superstructure  
Hull stiffened with longitudinal stringers supported by transverse bulkheads and floors
- 2 Deck**  
Fittings all in stainless steel  
8 stainless steel deck cleats  
Pulpit and cockpit rails  
Stainless steel fendering with rubber insert  
Stainless steel bow roller with anchor stop  
Stainless steel bow plate  
Delta anchor and 60m chain (galvanised)  
Electric winch and capstan with deck, cockpit and flybridge controls 24v  
Chain locker – fender stowage  
Curved safety glass windscreen  
3 x pantograph windscreen wipers 24v and washers  
Fuel fillers port and starboard  
Fresh water filler  
IMCO navigation lights  
Remote spotlight 24v  
Ensign staff and socket  
Fender tie bar under anchor locker lid  
8 fenders  
6 warps
- 3 Bathing platform**  
Hydraulic lifting platform  
Teak-laid bathing platform and steps  
Hot and cold swimming shower  
Fresh water marina connection  
Dockside AC shore power connection  
Stainless steel swimming ladder  
Stowage for fenders



4 Flybridge helm position

Access hatch and stairs to cockpit  
Self draining  
Acrylic deflecting spray screen  
Hydraulic steering  
Duplicate engine controls and instrumentation  
Duplicate autopilot controls  
Compass  
Steering indicator  
Trim tab control  
Seating for 6/8  
Folding table  
Upholstered sunbathing area  
Instrument cover  
Stainless steel guard rails and grab rails  
Glass holders  
Wetbar with hot and cold water and ice maker  
Radio/CD remote control  
Cockpit Speakers  
Low-level flybridge lights 24v  
Lighting under radar arch 24v

5 Aft cockpit

Teak-laid cockpit floor  
Self draining  
Moulded staircase to flybridge  
Stern seating  
Stern safety door  
Engine room access hatch  
2 x stern capstan winches 24v and fairleads  
Cockpit Speakers  
Overhead cockpit lights 24v  
Low-level courtesy lights aft cockpit 24v  
Low-level courtesy lights side deck 24v

6 Main helm console

Upholstered helm seats  
Console with walnut type fascia  
Hydraulic power steering  
Wooden rimmed steering wheel  
Radar/Chart plotter/GPS navigator  
Autopilot  
Full analogue engine instrumentation  
Electronic speedlog  
Depth sounder  
Rudder indicator  
Fresh water gauge  
Fuel gauge  
VHF radio dual station  
Trim tab controls  
Compass  
Horn  
Switch panels  
Windscreen wipers with washers  
Demisters  
Cigar lighter  
Glass holders  
Hand-held fire extinguisher  
Side opening door to side deck

7 Saloon

Large dining area with formal dining table  
Stainless steel sliding patio door to aft cockpit  
Air conditioning  
Flatscreen television  
Radio/CD/DVD cinema system  
Halogen overhead lighting 24v  
3 x double AC sockets  
Scatter cushions  
Choice of lacquered interior finishes and veneers  
Fitted carpet

8 Galley

Electric refrigerator and freezer  
Ceramic hob  
Microwave/Grill/Oven  
Stainless steel sink  
Hot and cold water  
Rubbish bin  
8 place crockery set  
8 place cutlery  
2 x double AC sockets  
Hand-held fire extinguisher  
Dishwasher  
First aid kit

9 VIP forward stateroom

Double berth  
Drawers and storage beneath  
Wardrobe with mirrored doors  
Dressing table with mirror and stool  
Halogen overhead lights 24v  
2 x reading lights 24v  
2 x opening portholes with mosquito screens and curtains  
Deck hatch with screen  
Double 240v AC socket  
Flatscreen television  
Air conditioning  
Door to en suite toilet/shower  
Fitted carpet

10 VIP en suite shower room

Vacuum toilet  
Wash basin  
Taps and accessories  
Separate shower compartment  
Extractor fan  
Mirrored vanity unit  
Shelved cupboard  
Toothbrush and glass holder  
Towel ring and towels  
Halogen overhead light 24v  
Opening porthole with mosquito screen and blind  
Razor socket 240/110v

11 Aft master stateroom

Double berth  
Under berth drawers and storage  
Bedside cabinets  
Fixed seat  
Dressing table with mirror and stool  
Lockers and drawers  
Halogen overhead lights 24v  
2 x reading lights 24v  
Large opening and fixed portholes  
2 x Double AC socket  
Flatscreen television  
Radio/CD/DVD player  
Air conditioning  
Wardrobe with mirrored doors  
Door to en suite toilet/shower  
Fitted carpet

12 Master en suite shower room

Vacuum toilet  
Wash basin  
Taps and accessories  
Separate shower compartment  
Extractor fan  
Mirrored vanity unit  
Shelved cupboard  
Toothbrush and glass holder  
Towel ring and towels  
Halogen overhead light 24v  
Opening porthole with mosquito screen and blind  
Razor socket 240/110v

13 Starboard guest cabin

2 single berths convert to a double  
Under-berth stowage  
Bedside table  
2 x reading lights 24v  
Wardrobe  
Halogen overhead lights 24v  
Opening porthole with mosquito screen and curtains  
Double AC socket  
Air conditioning  
Flatscreen television  
En suite shower room

14 Toilet/Shower room

Vacuum toilet  
Wash basin  
Taps and accessories  
Separate shower compartment  
Extractor fan  
Mirrored vanity unit  
Shelved cupboard  
Toothbrush and glass holder  
Towel ring and towels  
Halogen overhead light 24v  
Opening porthole with mosquito screen and blind  
Razor socket 240/110v

15 Port guest cabin

2 single Pullman berths  
Under-berth stowage  
2 x reading lights 24v  
Wardrobe  
Halogen overhead lights 24v  
Opening porthole with mosquito screen and curtains  
Double AC socket  
Air conditioning

16 Toilet/Shower room for port guest cabin

Vacuum toilet  
Wash basin  
Taps and accessories  
Separate shower compartment  
Extractor fan  
Mirrored vanity unit  
Shelved cupboard  
Toothbrush and glass holder  
Towel ring and towels  
Halogen overhead light 24v  
Opening porthole with mosquito screen and blind  
Razor socket 240/110v

17 Crew cabin

Entrance door from rear cockpit  
2 single or double berth  
Wardrobe and storage lockers  
Halogen overhead lighting 24v  
Reading light 24v  
AC double socket  
Air conditioning  
Washer Dryer  
Separate shower room with hot and cold water  
Mirror  
Opening porthole with mosquito screen  
Electric toilet and holding tank  
Shaver socket 240/110v

18Engine compartment and ancillaries

Twin engines  
Soundproofing throughout engine room  
2 x aluminium cross balanced fuel tanks with electric sending unit  
Separate fuel filters/water separators  
Automatic fire extinguishers  
Engine room and forward bilge flood alarms  
2 x automatic bilge pumps  
2 x automatic flood pumps  
4 x extractor fans 24v  
Manual bilge pump

19 Electrical system

Slow speed generator with underwater silent exhaust and sound box  
AC dockside connection  
Galvanic isolator  
24v and 12v DC electrical system with full circuit breaker protection  
8 x engine batteries 24v circuit  
8 x domestic batteries 24v circuit  
4 x generator batteries 12v circuit  
Alternator split charging system  
Remote battery switches controlled from locker in cockpit  
Battery charger for 24v circuits  
Battery charger for 12v circuits  
AC Water heater  
AC sockets throughout the boat  
24v hand light and cable

20 Underwater gear

Direct shaft drive through half tunnels  
5-blade NAB bronze propellers  
Bronze P-brackets  
2 x stainless steel Temet 25 shafts  
Dripless shaft logs with spare seals  
High-performance bronze rudders and struts  
Seawater strainers x 2 main engines  
1 x generator  
Seacocks on all underwater fittings  
Full cathodic bonding system to zinc anodes  
Bow thruster 24v  
Stainless steel hydraulic trim tabs 24v

21 Systems

Hydraulic power steering engine driven pump  
24v Vacuum toilet system  
Aluminium freshwater tank with electric sending unit  
24v fresh water pressure system  
Hot water tank

22 Miscellaneous

Tool kit  
Boat hook  
6 x Mooring warps  
8 x Fenders  
4 sets towels  
Vacuum cleaner

Optional extras

Passerelle  
Teak flybridge  
Teak side decks  
Second generator

US specification includes

US Coast Guard build regulations  
US specification appliances

FLYBRIDGE

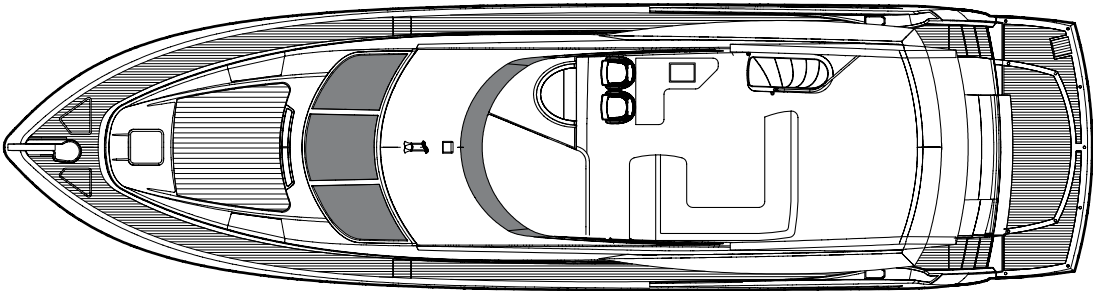

MAIN DECK

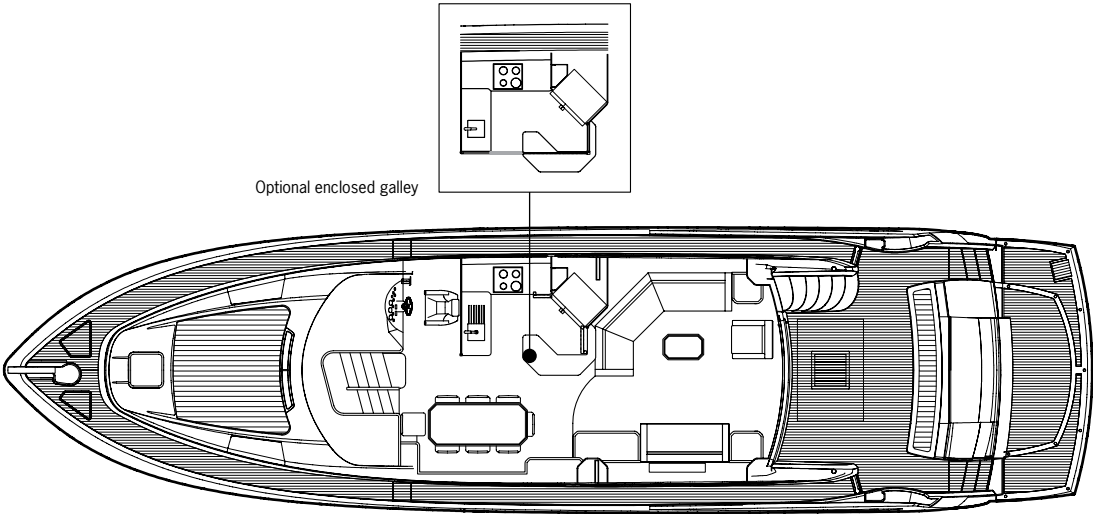

LOWER DECK

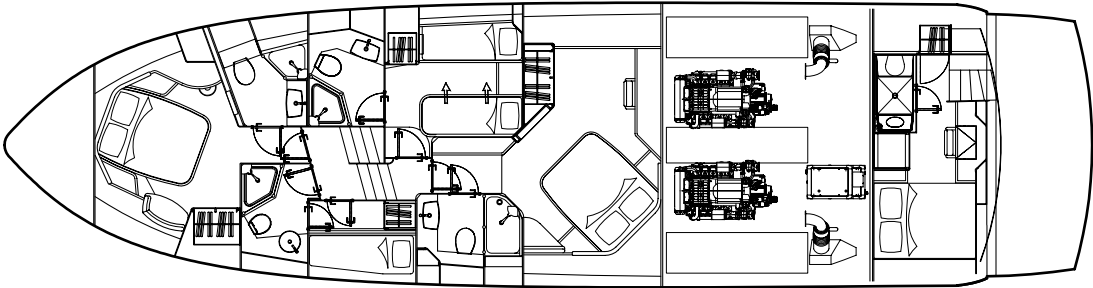



THE WORLD'S FINEST LUXURY MOTORYACHTS



Sunseeker International Limited has CE Approval which is compulsory for all boats with a LOA of 24m and below when sold in the EU.

\*Every attempt has been made to give accurate information, but performance and range figures are estimates given as a guide only. Dirt or growth on the hull, tuning of the engines, size, make of engines fitted, damage to propellers, the temperature of the air and water, the weight of fuel, water, stores, number of people, propeller pitch, quality of fuel and other matters, can all affect a boat's performance and range. For these and other reasons we can give no performance, range or other guarantees, and neither such guarantees nor anything contained herein constitutes an offer of contract or any representation or agreement, or may otherwise be relied upon. The photographs and artist's impressions in this brochure are of existing models in the Sunseeker range. There may be items shown in these photographs and artist's impressions that are not included in the standard inventory of the models shown. Specifications contained on the web site are samples only and should not be relied upon and may refer to models only intended for sale in a particular territory and not generally. No guarantee is given that any model will be available in any territory; however by contacting us we can advise you of models that are likely to be available in each territory. Actual specifications will be provided when a sales order or enquiry is placed with us or our approved Sunseeker dealer. Specifications for models sold in different markets may vary and specifications and models may be changed or withdrawn at any time without prior notice. The individual specification for each vessel will be agreed as part of the sale contract between the purchaser and the Sunseeker dealer. Dealers and distributors are independently owned and operated entities, and therefore Sunseeker dealers and distributors are not owned by Sunseeker International Limited or any subsidiaries or other related entity of this company nor are they their agents. Therefore they have absolutely no authority to commit Sunseeker International Limited, or any subsidiary or other related entities of Sunseeker International Limited to any pledge, contract or agreement in any form or by any means unless first accepted in writing by Sunseeker International Limited. In some examples herein Sunseeker have referred to measurements, specifications or other details applicable to a particular territory and no guarantee is given that these are applicable to your territory. For ease of reference we have, in some cases, referred to "we" or "Sunseeker" and these terms should be taken to mean Sunseeker International Limited.

Designed, written and produced by Marketing Matters Limited. Printed in England. August 2007. ©Sunseeker International.

**Naval architects**  
Don Shead/Sunseeker Design  
**Exterior styling**  
Sunseeker Design  
**Interior design**  
Sunseeker Design  
**Builder**  
Sunseeker International

For latest specifications visit  
[www.sunseeker.com](http://www.sunseeker.com)