

66



MANHATTAN 66

SPECIFICATION



The gracious Manhattan 66 boasts Sunseeker's hallmark flowing lines, perfect proportions and intersecting curves. Made for al fresco enjoyment, there is no better place to catch the sun or admire the scenery than on the flybridge. Luxurious touches abound, including flatscreen televisions in all cabins, state-of-the-art entertainment systems and stylish en suites, plus the option of an aft twin crew cabin.

- A:** Owner's stateroom
- B:** Galley
- C:** Cruising in comfort
- D:** Main saloon
- E:** Forward stateroom
- F:** WC and shower room



PRINCIPAL CHARACTERISTICS

Length overall – (incl. pulpit)	22.10m	72'6"	
Length hull – (incl. platform)	21.25m	69'9"	
Length waterline – (@ half load)	16.62m	54'6"	
Beam – (maximum)	5.20m	17'1"	
Height above waterline – (incl. light mast)	5.70m	18'8"	
Draft – (incl. props)	1.53m	5'0"	
Displacement – (@ half load)	35000kg	114829 lb	
Fuel capacity	3400 litres	748 GB gal.	898 US gal.
Fresh water capacity	950 litres	209 GB gal.	251 US gal.
Propulsion	Twin FP props in tunnels		
Engine options	up to 2100 PS (total)		
Fuel options	Diesel		
Generators	Standard		
	13kW @ 50Hz (Euro)		
	20kW @ 60Hz (US)		
	Upgrade		
	17kW @ 50Hz (Euro)		
Maximum speed	up to 33 knots*		
Cruising speed	up to 26 knots*		
Range	up to 300 nautical miles*		



PRINCIPAL FEATURES

Hydraulic lifting platform
Electric winch with deck, cockpit and flybridge controls
Side opening helm access door
Hot and cold swimming shower
Access from saloon to flybridge
Electronic echo sounder and speedlog
Power-assisted steering
Wetbar with hot and cold water
Ice makers
Flatscreen televisions in all cabins
DVD Hi-fi surround system
Hot and cold water system
Electric refrigerator and freezer
Ceramic hob and microwave/grill
Radar/Chart plotter with GPS
Autopilot
VHF radio
Trim tabs
Vacuum toilets with holding tank
Automatic fire extinguishers
Automatic bilge pumps
Slow speed generator with silent exhaust
AC shorepower/battery charger
Bow thruster
Fresh water marina connection
Teak bathing platform and steps
Teak cockpit floor
Demisters
Stern winches
Antifouling

All items included in standard specification.

US specification includes:
Air conditioning
Upgraded generator
US Coast Guard build regulations
US specification appliances

STANDARD SPECIFICATIONS

- 1 Construction**

Hand-laid GRP
Gel coat including stripes
Vinylester skin coat with powderbound mat
Stitched multi-axial reinforced single skin bottom
Balsa cored hull topsides
PVC foam cored deck and superstructure
Hull stiffened with longitudinal stringers supported by transverse bulkheads and floors
- 2 Deck**

Fittings all in stainless steel
8 stainless steel deck cleats
Pulpit and cockpit rails
Stainless steel fendering with rubber insert
Stainless steel bow roller with anchor stop
Stainless steel bow plate
Delta anchor and 60m chain (galvanised)
Electric winch and capstan with deck, cockpit and flybridge controls 24v
Chain locker – fender stowage
Curved safety glass windscreen
3 x pantograph windscreen wipers 24v and washers
Fuel fillers port and starboard
Fresh water filler
IMCO navigation lights
Remote spotlight 24v
Ensign staff and socket
Fender tie bar under anchor locker lid
6 fenders
4 warps
- 3 Bathing platform**

Hydraulic lifting platform
Teak-laid bathing platform and steps
Hot and cold swimming shower
Fresh water marina connection
Dockside AC shore power connection
Stainless steel swimming ladder
Stowage for fenders



4 Flybridge helm position

Access hatch and stairs to saloon and cockpit
Self draining
Acrylic deflecting spray screen
Hydraulic steering
Duplicate engine controls and instrumentation
Duplicate autopilot controls
Compass
Steering indicator
Trim tab control
Seating for 6/8
Folding table
Upholstered sunbathing area
Instrument cover
Stainless steel guard rails and grab rails
Glass holders
Wetbar with hot and cold water and ice maker
Radio/CD remote control
Cockpit speakers
Low-level flybridge lights 24v
Lighting under radar arch 24v

5 Aft cockpit

Teak-laid cockpit floor
Self draining
Moulded staircase to flybridge
Stern seating
Stern safety door
Engine room access hatch
Ice maker
2 x stern capstan winches 24v and fairleads
Cockpit speakers
Overhead cockpit lights 24v
Low-level courtesy lights aft cockpit 24v
Low-level courtesy lights side deck 24v

6 Main helm console

Upholstered electric helm seat
Console with walnut type fascia
Hydraulic power steering
Wooden rimmed steering wheel
Radar/Chart plotter/GPS navigator
Autopilot
Full analogue engine instrumentation
Electronic speedlog
Depth sounder
Rudder indicator
Fresh water gauge
Fuel gauge
VHF radio dual station
Trim tab controls
Compass
Horn
Switch panels
Windscreen wipers with washers
Demisters
Cigar lighter
Glass holders
Hand-held fire extinguisher
Side opening door to side deck

7 Saloon

Large dining area with seating around folding table
Stainless steel sliding patio door to aft cockpit
Scatter cushions
Flatscreen television
Hi-fi radio/CD/DVD surround system
Halogen overhead lighting 24v
Low-level lights 24v
2 x double AC sockets
Choice of lacquered interior finishes and veneers
Fitted carpet

8 Galley

Electric refrigerator and freezer
Ceramic hob
Microwave/Grill/Oven
Stainless steel sink
Hot and cold water
Rubbish bin
8 place crockery set
8 place cutlery set
2 x double AC sockets
Hand-held fire extinguisher
Dishwasher
First aid kit

9 VIP stateroom forward

Double berth
Drawers and storage beneath
Wardrobe with mirrored doors
Dressing table with mirror and stool
Halogen overhead lights 24v
2 x reading lights 24v
2 x opening portholes with mosquito screens and curtains
Deck hatch with screen
Double AC socket
Flatscreen television
Door to en suite toilet/shower
Fitted carpet

10 VIP en suite shower room

Vacuum toilet
Avonite counter top
Washbasin
Taps and accessories
Separate shower compartment
Extractor fan
Mirrored vanity unit
Shelved cupboard
Toothbrush and glass holder
Towel ring and towels
Halogen overhead light 24v
Opening porthole with mosquito screen and blind
Shaver socket 240/110v

11 Aft master stateroom

Double berth
Drawers and storage beneath
Bedside cabinets
Settee
Dressing table with mirror and stool
Halogen overhead lights 24v
2 x reading lights 24v
Large opening and fixed portholes
Double AC socket
Flatscreen television
Radio/CD/DVD player
Door to en suite toilet/shower
Door to walk-in wardrobe
Fitted carpet

12 Master en suite shower room

Vacuum toilet
Avonite counter top
Two washbasins
Taps and accessories
Separate shower compartment
Extractor fan
Mirrored vanity unit
Shelved cupboard
Toothbrush and glass holder
Towel ring and towels
Halogen overhead light 24v
Opening porthole with mosquito screen and blind
Shaver socket 240/110v

13 Starboard guest cabin

2 single berths
Under-berth stowage and drawers
Bedside table
2 x reading lights 24v
Wardrobe
Halogen overhead lights 24v
Opening porthole with mosquito screen and curtains
Double AC socket
Flatscreen television
En suite shower room

14 Toilet/Shower room

Vacuum toilet
Avonite counter top
Washbasin
Taps and accessories
Separate shower compartment
Extractor fan
Mirrored vanity unit
Shelved cupboard
Toothbrush and glass holder
Towel ring and towels
Halogen overhead light 24v
Opening porthole with mosquito screen and blind
Shaver socket 240/110v

15 Crew cabin (option)

Entrance door from rear cockpit
2 single berths
Hanging rail
Halogen overhead lighting 24v
Reading light 24v
AC socket
Separate shower room with hot and cold water
Mirror
Opening porthole with mosquito screen
Electric toilet and holding tank
Shaver point 240/110v

16 Engine compartment and ancillaries

Twin engines
Soundproofing throughout engine room
2 x aluminium cross balanced fuel tanks with electric sending unit
Separate fuel filters/water separators
Automatic fire extinguishers
Engine room and forward bilge flood alarms
2 x automatic bilge pumps
2 x automatic flood pumps
4 x extractor fans 24v
Manual bilge pump

17 Electrical system

Slow speed generator with underwater silent exhaust and sound box
AC dockside connection
Galvanic isolator
24v and 12v DC electrical system with full circuit breaker protection
6 x engine batteries 24v circuit
4 x domestic batteries 24v circuit
2 x generator batteries 12v circuit
Alternator split charging system
Remote battery switches controlled from locker in cockpit
Battery charger for 24v circuits
Battery charger for 12v circuits
AC water heater
AC sockets throughout the boat
24v hand light and cable

18 Underwater gear

Direct shaft drive through half tunnels
5-blade NAB bronze propellers
Bronze P-brackets
2 x 60 mm stainless steel Temet 25 shafts
Dripless shaft logs with spare seals
High-performance bronze rudders and struts
Seawater strainers – 2 x main engines/
1 x generator
Seacocks on all underwater fittings
Full cathodic bonding system to zinc anodes
Bow thruster 24v
Stainless steel hydraulic trim tabs 24v

19 Systems

Hydraulic power steering engine driven pump
24v vacuum toilet system
Aluminium freshwater tank with electric sending unit
24v fresh water pressure system
Hot water tank
Washer dryer

20 Miscellaneous

Toolkit
Boat hook
4 x mooring ropes
6 x fenders
Spare bulbs and fuses
3 sets towels
Vacuum cleaner

21 Optional extras

Crew cabin
Passerelle
Air conditioning
Upgraded generator
Teak side decks
Port Pullman cabin in lieu of utility space

US specification includes

Air conditioning
Upgraded generator
US Coast Guard build regulations
US specification appliances

FLYBRIDGE

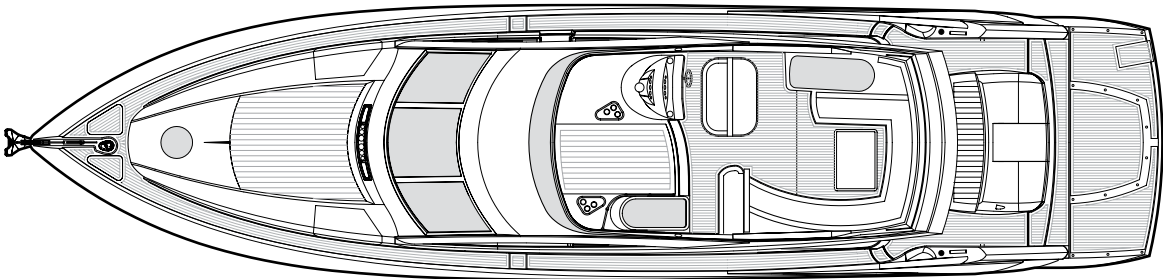

MAIN DECK

Optional passerelle

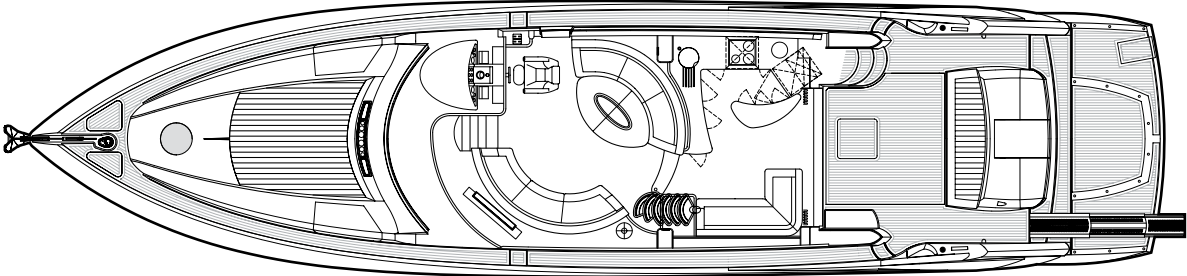

LOWER DECK

Optional crew cabin

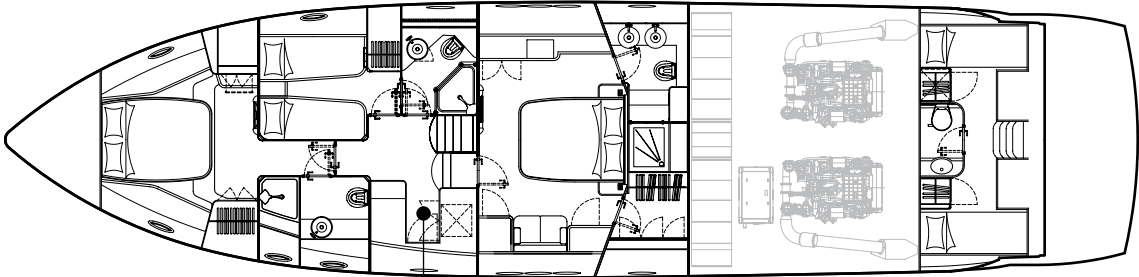

Optional pullman cabin

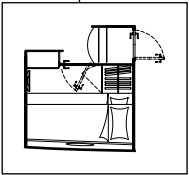



THE WORLD'S FINEST LUXURY MOTORYACHTS



Sunseeker International Limited has CE Approval which is compulsory for all boats with a LOA of 24m and below when sold in the EU.

*Every attempt has been made to give accurate information, but performance and range figures are estimates given as a guide only. Dirt or growth on the hull, tuning of the engines, size, make of engines fitted, damage to propellers, the temperature of the air and water, the weight of fuel, water, stores, number of people, propeller pitch, quality of fuel and other matters, can all affect a boat's performance and range. For these and other reasons we can give no performance, range or other guarantees, and neither such guarantees nor anything contained herein constitutes an offer of contract or any representation or agreement, or may otherwise be relied upon. The photographs and artist's impressions in this brochure are of existing models in the Sunseeker range. There may be items shown in these photographs and artist's impressions that are not included in the standard inventory of the models shown. Specifications contained on the web site are samples only and should not be relied upon and may refer to models only intended for sale in a particular territory and not generally. No guarantee is given that any model will be available in any territory; however by contacting us we can advise you of models that are likely to be available in each territory. Actual specifications will be provided when a sales order or enquiry is placed with us or our approved Sunseeker dealer. Specifications for models sold in different markets may vary and specifications and models may be changed or withdrawn at any time without prior notice. The individual specification for each vessel will be agreed as part of the sale contract between the purchaser and the Sunseeker dealer. Dealers and distributors are independently owned and operated entities, and therefore Sunseeker dealers and distributors are not owned by Sunseeker International Limited or any subsidiaries or other related entity of this company nor are they their agents. Therefore they have absolutely no authority to commit Sunseeker International Limited, or any subsidiary or other related entities of Sunseeker International Limited to any pledge, contract or agreement in any form or by any means unless first accepted in writing by Sunseeker International Limited. In some examples herein Sunseeker have referred to measurements, specifications or other details applicable to a particular territory and no guarantee is given that these are applicable to your territory. For ease of reference we have, in some cases, referred to "we" or "Sunseeker" and these terms should be taken to mean Sunseeker International Limited.

Designed, written and produced by Marketing Matters Limited. Printed in England. August 2007. ©Sunseeker International.

Naval architects
Don Shead/Sunseeker Design
Exterior styling
Sunseeker Design
Interior design
Sunseeker Design
Builder
Sunseeker International

For latest specifications visit
www.sunseeker.com