

60



MANHATTAN 60

SPECIFICATION



Packed with charm and sophistication, the Manhattan 60 is designed to impress. With curvaceous exterior lines and spacious living areas, this boat will captivate guests and onlookers alike. With three engine options to choose from, you can achieve up to 32 knots and cruise comfortably at 23. And there's space for friends and family with accommodation for six, plus crew.

- A:** At anchor
- B:** Aft cockpit seating
- C:** Flybridge
- D:** WC and shower room
- E:** Main saloon
- F:** Forward stateroom
- G:** Galley



PRINCIPAL CHARACTERISTICS – Provisional

Length overall – (incl. pulpit)	19.60m	64'4"	
Length hull – (incl. platform)	19.10m	62'8"	
Length waterline – (@ half load)	14.67m	48'2"	
Beam – (maximum)	5.00m	16'5"	
Draft – (incl. props)	1.49m	4'11"	
Displacement – (@ half load)	31000kg	101706 lb	
Fuel capacity	3000 litres	660 GB gal.	793 US gal.
Fresh water capacity	700 litres	154 GB gal.	185 US gal.
Propulsion	Twin FP props in tunnels		
Engine options	up to 1800 PS (total)		
Fuel options	Diesel		
Generators	Standard		
	9kW @ 50Hz (Euro)		
	15kW @ 60Hz (US)		
	Upgrade		
	13kW @ 50Hz (Euro)		
Maximum speed	up to 32 knots*		
Cruising speed	up to 23 knots*		
Range	up to 270 nautical miles*		

All principal characteristics and specifications are provisional

PRINCIPAL FEATURES – Provisional

Electric winch with bow roller, flybridge and cockpit controls Hot and cold swimming shower Sliding cockpit door to aft cockpit Flatscreen televisions in all cabins Radio/CD player DVD surround system in saloon Electric refrigerator Electric freezer Ceramic hob Microwave/Grill/Oven Radar/Chart plotter with GPS Autopilot Bow thruster Electric speedlog Depth sounder VHF radio dual station Trim tabs Hydraulic steering Hot and cold water system Automatic fire extinguishers Automatic bilge pumps Generator AC shorepower/battery charger Teak bathing platform and steps Teak cockpit floor	Fresh water marina connection Vacuum toilets with holding tank Remote spotlight Demisters Side opening helm door Antifouling Hydraulic lifting platform
All items included in standard specification.	
US specification includes: Air conditioning Upgraded generator US Coast Guard build regulations US specification appliances	



STANDARD SPECIFICATIONS

1 Construction

Hand-laid GRP
Gel coat including stripes
Isophthalic polyester skin coat with powderbound mat
Stitched multi-axial reinforced single skin bottom
Balsa cored hull topsides and deck
Hull stiffened with longitudinal stringers supported by transverse bulkheads and floors
Antifouling

2 Deck

Fittings all in stainless steel
8 x deck cleats in stainless steel
Delta anchor and 45m chain (galvanised)
Electric winch and capstan 24v with deck and cockpit controls 24v
Stemhead roller and anchor stop
Self draining chain locker-fender stowage
Pulpit and cockpit rails in stainless steel
Stainless steel fendering with rubber insert
IMCO navigation lights
2 x pantograph wipers 24v, windscreen washers
Ensign staff and socket
6 x fenders and 4 warps
Remote spotlight 24v
Curved safety glass windscreen

3 Bathing platform

Fresh water marina connection
Dockside AC shore power connection
Hot and cold swimming shower
Teak-laid bathing platform
Foldaway stainless steel swimming ladder
Hydraulic lifting platform

4 Aft cockpit

Self-draining
Moulded staircase to flybridge
Transom storage locker
Upholstered seating
Transom safety door
Engine room access hatch
Overhead lighting 24v
Low-level courtesy lighting 24v
2 external speakers
Teak-laid cockpit and steps
Boat hook
Hand-held fire extinguisher

5 Flybridge helm position

Self-draining
Deflecting screen (acrylic)
Hydraulic steering
Wood rimmed steering wheel
Duplicate engine controls and instrumentation
Compass
Trim tab control
Echo sounder and speedlog repeaters
Bow thruster control
Autopilot and GPS navigator controls
Instrument cover
Upholstered seating
Storage below seats
Cockpit table
Sunbathing area forward
Stainless steel guard rails and grab rails
Glass holders
Radio/CD remote control
2 external speakers
Low-level courtesy lights

6 Saloon

Large dining area with folding dining table
Lower saloon seating
Stainless steel sliding cockpit door to aft deck
Drinks cabinet
Flatscreen television
DVD Hi-fi surround system
CD Radio for external speakers
Halogen overhead lighting 24v
2 x double AC socket
Main switch panel (AC/DC) with circuit breaker protection and generator controls
Choice of lacquered interior finishes and veneer
Scatter cushions
Fitted carpet

7 Galley

Sink and drainer
Hot and cold water
Electric refrigerator
Electric freezer
Ceramic hob
Hob extractor fan
Microwave/Combination oven
Rubbish bin
6 place crockery set
6 place cutlery set
Cupboard and drawer storage
2 x double AC socket
Hand-held fire extinguisher
First aid kit

8 Main helm console

Upholstered double helm seat
Console with burr walnut type fascia
Hydraulic steering
Wood rimmed steering wheel
Radar/Plotter
Autopilot
VHF radio dual station
Full analogue engine instrumentation
Electric speedlog
Depth sounder
Rudder indicator
Compass
Bow thruster control
Horn
Windscreen wipers and washers
Trim tab controls
Cigar lighter
Opening helm side door
Glass holders
Hand-held fire extinguisher

9 Master aft cabin

Double berth
2 x reading lights 24v
Outboard shelving
Bedside cupboards
Walk-in hanging wardrobe
Dressing table with stool
Settee
Halogen overhead lighting 24v
2 x large opening portholes and 4 x fixed with curtains
2 x double AC socket
Flatscreen television
Fitted carpet

10 Master en suite shower room

Vacuum toilet
Avonite counter top
Washbasin
Taps and accessories
Separate shower compartment
Extractor fan
Mirrored vanity unit
Shelved cupboard
Toothbrush and glass holder
Towel ring and towels
Halogen overhead light 24v
Opening porthole with mosquito screen and blind
Shaver socket 240/110v

11 VIP forward stateroom

Double berth
Drawers and storage beneath
Wardrobe with mirrored doors
Halogen overhead lights 24v
2 x reading lights 24v
2 x opening portholes with mosquito screens and curtains
Deck hatch with screen
Double 240v AC socket
Flatscreen television
Door to en suite toilet/shower
Fitted carpet

12 Forward en suite shower room and toilet

Vacuum toilet
Avonite counter top
Shower taps and accessories
Washbasin
Separate shower compartment
Extractor fan
Shaver socket 240/110v
Mirrored cupboard
Towel rails
Bath and hand towels
Halogen overhead lights
Opening porthole with venetian blind
Door to stateroom

13 Starboard guest cabin

2 x single berths
Bedside table with drawer
2 x reading lights
Under-berth stowage
Full hanging wardrobe
Halogen overhead lights
Opening porthole with mosquito screen and curtain
Double AC socket
Door to en suite shower room
Flatscreen television
Fitted carpet

14 Starboard guest shower and toilet/day head

Vacuum toilet
Avonite counter top
Shower taps and accessories
Washbasin
Separate shower compartment
Extractor fan
Shaver socket 240/110v
Mirrored cupboard
Towel rail
Bath and hand towels
Halogen overhead lights
Opening porthole with venetian blind

15 Engine compartment and ancillaries

Twin engines with close coupled V-drive gearboxes
2 x separate fuel filters water separators
1 x fuel tank with electric sender unit
Fresh water engine top-up hose
Sound insulation throughout engine room
Automatic fire extinguisher
2 x automatic bilge pumps
1 x automatic flood pump
Bilge water high-level alarm
Extractor fans 24v
Manual bilge pump

16 Electrical system

Generator with underwater silent exhaust
AC dockside connection
Main DC and AC electrical circuits protected by re-settable circuit breakers
Systems monitoring panel
Galvanic isolator
6 x batteries for engine starting 24v circuit
4 x batteries for domestic power 24v circuit
2 x batteries for generator starting 12v circuit
Battery coupling system
Battery switches controlled from locker in cockpit
Alternator split charging system
Battery charger for 24v circuits
Battery charger for 12v circuits
Water heater
AC outlet sockets throughout the boat
24v hand light and cable

17 Underwater gear

Direct shaft drive though half tunnels
4-bladed NAB bronze propellers
Bronze P-brackets
2 x stainless steel shafts
Dripless shaft logs
High-performance bronze rudders and struts
Seawater strainers – 2 x main engines/
1 x generators
Seacocks on all underwater fittings
Bow thruster 24v
Stainless steel trimtabs (hydraulic)
Full cathodic bonding system to zinc anodes

18 Systems

Aluminium fresh water tank
24v fresh water pressure system
Hot water tank
24v vacuum toilet system

19 Miscellaneous

Toolkit
Boat hook
4 x mooring ropes
6 x fenders
Spare bulbs and fuses
2 x towel sets

20 Optional extras

Bimini top
Twin berth crew cabin aft with separate toilet
Teak flybridge decking
Hydraulic Passerelle
Air-conditioning
Upgraded generator
Washer/Dryer

US specification includes

Air conditioning
Upgraded generator
US Coast Guard build regulations
US specification appliances

FLYBRIDGE

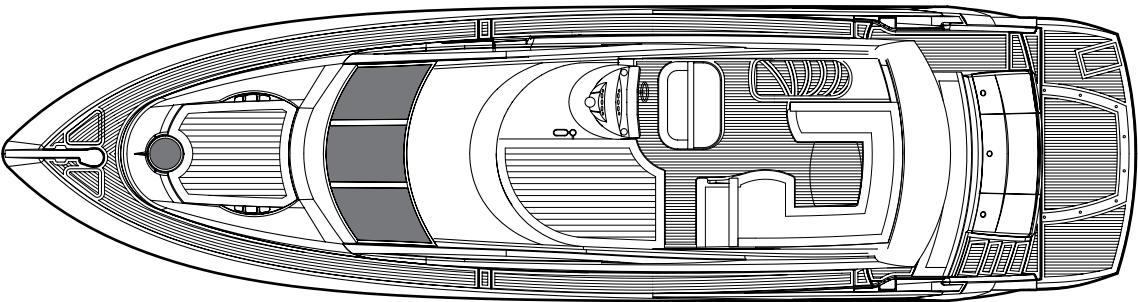

MAIN DECK

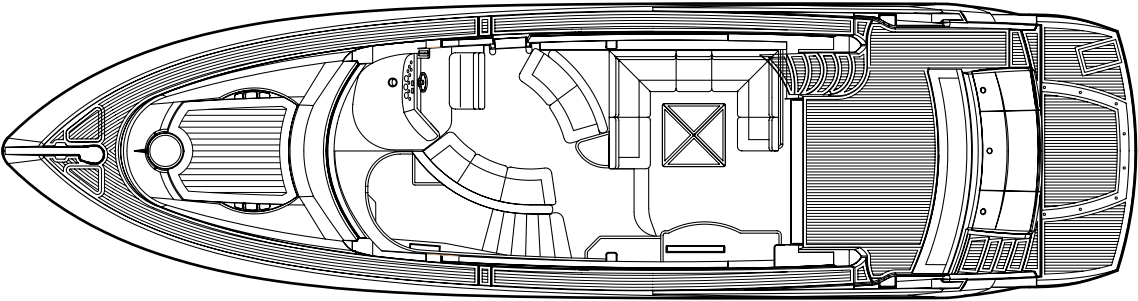

LOWER DECK

Optional crew cabin

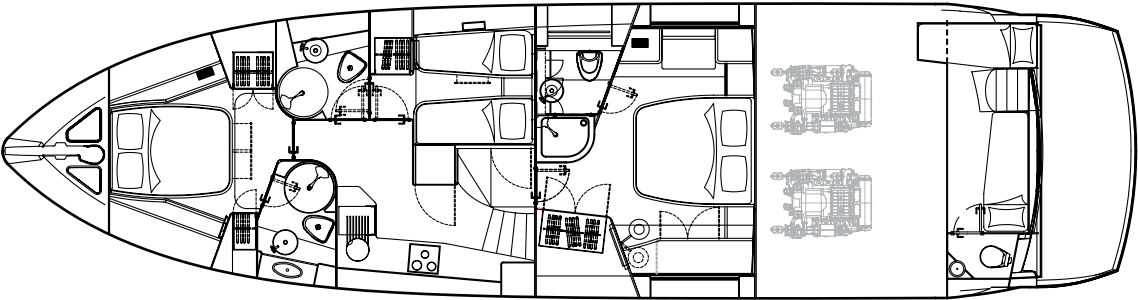



THE WORLD'S FINEST LUXURY MOTORYACHTS



Sunseeker International Limited has CE Approval which is compulsory for all boats with a LOA of 24m and below when sold in the EU.

*Every attempt has been made to give accurate information, but performance and range figures are estimates given as a guide only. Dirt or growth on the hull, tuning of the engines, size, make of engines fitted, damage to propellers, the temperature of the air and water, the weight of fuel, water, stores, number of people, propeller pitch, quality of fuel and other matters, can all affect a boat's performance and range. For these and other reasons we can give no performance, range or other guarantees, and neither such guarantees nor anything contained herein constitutes an offer of contract or any representation or agreement, or may otherwise be relied upon. The photographs and artist's impressions in this brochure are of existing models in the Sunseeker range. There may be items shown in these photographs and artist's impressions that are not included in the standard inventory of the models shown. Specifications contained on the web site are samples only and should not be relied upon and may refer to models only intended for sale in a particular territory and not generally. No guarantee is given that any model will be available in any territory; however by contacting us we can advise you of models that are likely to be available in each territory. Actual specifications will be provided when a sales order or enquiry is placed with us or our approved Sunseeker dealer. Specifications for models sold in different markets may vary and specifications and models may be changed or withdrawn at any time without prior notice. The individual specification for each vessel will be agreed as part of the sale contract between the purchaser and the Sunseeker dealer. Dealers and distributors are independently owned and operated entities, and therefore Sunseeker dealers and distributors are not owned by Sunseeker International Limited or any subsidiaries or other related entity of this company nor are they their agents. Therefore they have absolutely no authority to commit Sunseeker International Limited, or any subsidiary or other related entities of Sunseeker International Limited to any pledge, contract or agreement in any form or by any means unless first accepted in writing by Sunseeker International Limited. In some examples herein Sunseeker have referred to measurements, specifications or other details applicable to a particular territory and no guarantee is given that these are applicable to your territory. For ease of reference we have, in some cases, referred to "we" or "Sunseeker" and these terms should be taken to mean Sunseeker International Limited.

Designed, written and produced by Marketing Matters Limited. Printed in England. August 2007. ©Sunseeker International.

Naval architects
Don Shead/Sunseeker Design
Exterior styling
Sunseeker Design
Interior design
Sunseeker Design
Builder
Sunseeker International

www.sunseeker.com