

90



SUNSEEKER 90 YACHT

SPECIFICATION



From its sleek prow to the teak-laid bathing platform aft, the 90 Yacht encompasses every conceivable refinement, plus Sunseeker's inimitable performance that powers this Yacht to speeds of up to 30 knots. Stunning living areas, four deluxe en suite cabins and a layout that lets crew move around while maintaining guests privacy make the 90 Yacht a classic Sunseeker.

- A:** Forward VIP stateroom
- B:** WC and shower room
- C:** Owner's stateroom
- D:** Twin guest cabin
- E:** Main saloon
- F:** Galley
- G:** Enclosed wheelhouse

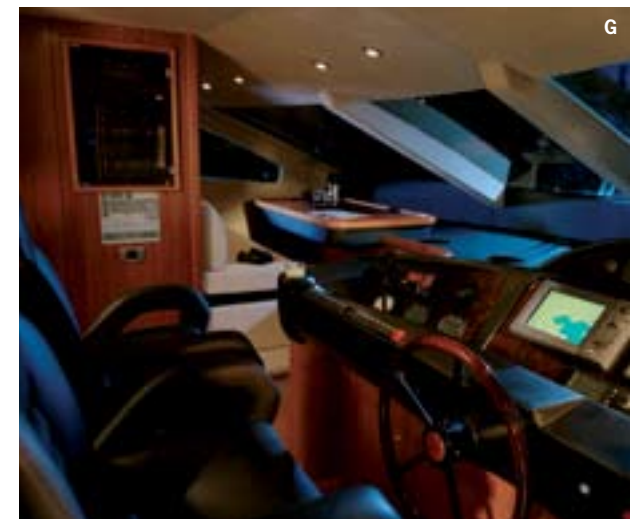

PRINCIPAL CHARACTERISTICS

Length overall – (incl. pulpit and platform)	28.0m	91'11"
Length waterline – (@ half load)	20.29m	66'7"
Beam – (maximum)	6.3m	20'8"
Draught – (incl. props)	2.00m	6'7"
Displacement – (@ half load)	71000kg	156628 lb
Fuel capacity	8500 litres	1870 GB gal. 2246 US gal.
Fresh water capacity	1500 litres	330 GB gal. 396 US gal.
Propulsion	2 x submerged props in semi-tunnels	
Engine options	Up to 3650 PS (total)	
Fuel options	Diesel	
Maximum speed	up to 30 knots* (subject to engine option and specification)	
Range	up to 450 nautical miles* (subject to engine option and specification)	

PRINCIPAL FEATURES

Built to European specification 220v single phase 50Hz	Toilet system with holding tank
or	Automatic fire extinguishing system for engine room
Built to USCG Regulations 220v/110v single phase 60Hz	Automatic bilge pumps
Air conditioning	Slow speed generators with silent exhausts
Hydraulic lifting platform	AC shorepower/battery charger
Electric winch with foredeck control	Bow thruster
Side opening wheelhouse and galley access door	Stern thruster
Hot and cold swimming shower at stern	Trim tabs
Power-assisted steering at wheelhouse and flybridge helm positions	Fire detection system
Flybridge wetbar with sink, ice maker, fridge and griddle	Remote controlled spotlight at bow
Flatscreen televisions in all guest cabins and crew mess	Deckwash with outlets forward, aft and flybridge
Hi-fi surround-sound system DVD/CD/radio in saloon and master stateroom	Fresh water marina connection
Electric refrigerator, freezer and ice maker	Teak bathing platform and steps
Ceramic hob, microwave/oven and dishwasher	Teak side decks
Electronic depth and speed displays	Teak cockpit floor
Radar/Chart plotter with GPS	Screen demisters
Autopilot	Stern winches
VHF radio (dual station)	Antifouling
Hot and cold water system	
Fresh water pump	

All items included in standard specification.

USA specification includes:
 Upgraded generators
 US Coast Guard build regulations
 US specification appliances



STANDARD SPECIFICATIONS

1 Construction

Hand-laid GRP
Gel coat including stripes
Vinylester skin coat with powderbound mat
Stitched multi-axial reinforced single skin bottom
Balsa cored hull topsides
PVC foam cored deck and superstructure
Hull stiffened with longitudinal stringers supported by transverse bulkheads and floors

2 Deck

Three pairs of spring cleats with chafing bars
Pair of bow cleats and fairleads
Fittings in Stainless steel
Pair stern cleats and fairleads
Pulpit and cockpit rails
Stainless steel bow roller with anchor stop
Stainless steel bow plate
Automatic fresh water chain wash
Fresh water deckwash with outlets forward and aft
Chain locker
Curved direct glazed safety glass windscreen
Pantograph windscreen wipers and washers
Fuel fillers port and starboard
Fresh water filler
IMCO navigation lights
Remote controlled spotlight at bow
Low-level courtesy lights on side decks 24v
Ensign staff and socket
Bow seat and sunbathing pad
Teak laid sidedecks
80kg galvanised anchor
100m of anchor chain, 14mm diameter (galvanised)
Electric winch and capstan with foredeck controls
Escape hatch to foredeck from VIP Stateroom

3 Flybridge

Acrylic deflecting spray screen
Seating areas
Storage lockers under seating
Teak dining table with GRP base
Upholstered sunbathing area forward
Stainless steel aft safety rails
Glass holders
Wetbar with sink
Fire extinguisher in wetbar locker
Deckwash outlet
Low-level flybridge lighting 24v
Radar arch structure
Two pairs marine speakers connected to CD/radio in saloon
Ice maker in wetbar
Fridge in wetbar
Bar stools X 3
Ceramic griddle in wetbar
Self draining cockpit

4 Flybridge helm position

Hydraulic steering
Autopilot repeater
Radar/Chartplotter with GPS repeater (1 x display)
Depth and speed multi display
VHF second station
Remote spotlight control
Manual compass
Steering indicator
Trim tab control
Horn control
Instrument cover
Radio/CD remote keypad
Waterproof plug and socket 12v
Bench seat
Duplicate engine throttle controls
Analogue engine instrumentation

5 Aft cockpit

Teak laid cockpit floor
Self draining
Stairs to flybridge with teak treads
Aft fixed bench seating
Teak table with folding leaves on GRP base
Stern safety gates
Engine room access hatch
2 x stern capstan winches 24v and fairleads
Overhead cockpit lights 24v
Low-level courtesy lights 24v
Pair marine speakers connected to flybridge CD/radio system
Fire extinguisher in seat base
Aft rope lockers
Battery switches in locker
Euro Specification only: Dockside AC connection sockets
2 x 63amp
US Specification only: Dockside AC connection 1 X 100 amp
Glendinning cablemaster

6 Bathing platform

Stairs to aft cockpit with teak treads
Teak-laid Hydraulic lifting bathing platform
Fold out stainless steel swimming ladder
Access door to crew quarters
Hydraulic telescopic gangway
Hot and cold hand-held swimming shower
Fresh water marina connection
Telephone marina connection
Starboard side door to lazarette

7 Boat covers

Windscreen sun screen
Flybridge instrument cover
Euro Specification only: Aft cockpit camper with windows

8 Main saloon and dining

Control head for flybridge CD/radio system
Air conditioning
Side windows with blinds
Bar with granite top
Stainless steel framed sliding patio door to aft cockpit with curtains and tie back
Halogen overhead lighting 24v
Double AC sockets
Telephone point (aft port side)
2 x table lamps
Coffee table
Sofa seating in aft saloon with scatter cushions
Dining table
Eight free-standing dining chairs
Three bar stools
Drinks cabinet with glassware stowage for eight (8 x Champagne, 8 x whisky, 1 x decanter)
LCD Flatscreen television (42") on rise and fall
DVD/CD/Radio surround sound entertainment system (five speakers and sub-woofer)
Sensor connected to fire detection system
I-Pod docking station connected to surround sound system

9 Day head

Tecma toilet 24v
Granite floor
Washbasin
Taps and accessories
Mirror
Extractor fan
Halogen overhead lighting 24v

10 Galley

American style fridge/freezer with ice maker
4-ring ceramic hob AC
Hob extractor AC
Slimline dishwasher AC
Stainless steel sink
Hot and cold water
Rubbish bin
8 place crockery set
8 place cutlery set
Storage consisting of cupboards, drawers and top-box lockers
Halogen overhead lighting 24v
Spotlights under top box lockers
Double AC sockets
Fire extinguisher
Fire blanket
First aid kit
Side opening door to port sidedeck
Telephone point
Sensor connected to fire detection system
Euro Specification only: Microwave/Oven AC
USA Specification only: Oven AC
USA Specification only: Small microwave AC

11 Wheelhouse

Sofa seat
Double AC sockets
2 x telephone points
2 x upholstered helm seats
Console with walnut effect fascia
Hydraulic power steering
Wooden rimmed steering wheel
Radar/Chartplotter with GPS (2 x displays)
Autopilot
Depth and speed displays
VHF radio dual station
Manual compass
Horn control
Switch panels
Remote spotlight control
Trim tab controls
Rudder indicator
Full analogue engine instrumentation
Fresh water gauge
Fuel gauge
Cigar lighter
Main control panel (AC/DC) with generators control
Monitoring panel for fire detection system
Screen demister
Glass holder
Fire extinguisher
Doors to Galley and Saloon area
Table with chart stowage
Side opening door to starboard side deck
Windscreen wipers with washers
Sensor connected to fire detection system

12 Lower Lobby

Halogen overhead lighting 24v
AC socket
Bilge access hatches
Doors to guest cabins
Fitted carpet
Sensor connected to fire detection system

13 Forward VIP stateroom

Double berth
Foam mattress for berth
Storage beneath berth
Drawers in berth-end
Bedside lights 24v
Dressing table with stool
Sofa
Air conditioning
LCD flatscreen television (42")
DVD/CD player with two speakers
Halogen overhead lighting 24v
Opening portholes with mosquito screen and roman blinds
Escape hatch to foredeck
Double AC socket
Telephone point x 2 (port bedside and dressing table)
Door to en suite toilet/shower room and walk-in wardrobe
Fitted carpet
Sensor connected to fire detection system

14 Forward VIP walk-in wardrobe

Hanging rails
Drawers
Shelves
Full-length mirror
Halogen overhead lighting 24v
Fitted carpet
Door to stateroom

15 Forward VIP en suite

Granite vanity top and flooring
Tecma toilet 24v
Washbasin
Taps and accessories (toothbrush and glass holder, soap dish, towel rails and towels)
Hot and cold water
Separate shower compartment
Acrylic shower door
Air conditioning outlet
Extractor fan
Mirrored vanity unit
Shelved cupboard
Halogen overhead lighting 24v
Opening porthole with mosquito screen and Venetian blind
Shaver socket 240/110v

16 Port guest cabin

Two single berths
Foam mattresses for berths
2 x reading lights 24v
Bedside unit with storage
Wardrobe
Air conditioning
Halogen overhead lighting 24v
Three vertical portholes (centre opening with mosquito screen) and blind
Double AC sockets
LCD flatscreen television (20")
DVD/CD player with two speakers
Telephone point (beside bedside table)
Fitted carpet
Door to en suite and lobby
Sensor connected to fire detection system

17 Port guest cabin en suite

Granite vanity top and flooring
Tecma toilet 24v
Washbasin
Taps and accessories (toothbrush and glass holder, soap dish, towel rails and towels)
Separate shower compartment
Acrylic shower door
Extractor fan
Air conditioning outlet
Mirrored vanity unit
Shelved cupboard
Halogen overhead lighting 24v
Opening porthole with mosquito screen and Venetian blind
Shaver socket 240/110v
Door to guest cabin

18 Starboard guest cabin

Two single berths
Under berth stowage
2 x reading lights 24v
Bedside unit with storage
Wardrobe
Air conditioning
Halogen overhead lighting 24v
Three vertical portholes (centre opening with mosquito screen) and blind
Double AC sockets
Door to en suite toilet/shower room
LCD flatscreen television (20")
DVD/CD player with two speakers
Telephone point (beside bedside table)
Fitted carpet
Doors to en suite and lobby
Foam mattresses for berths

19 Starboard guest cabin en suite

Granite vanity top and flooring
Tecma toilet 24v
Washbasin
Taps and accessories (toothbrush and glass holder, soap dish, towel rails and towels)
Separate shower compartment
Acrylic shower door
Extractor fan
Air conditioning outlet
Mirrored vanity unit
Shelved cupboard
Halogen overhead lighting 24v
Opening porthole with mosquito screen and Venetian blind
Shaver socket 240/110v
Door to guest cabin

20 Master aft stateroom

Storage beneath berth
Drawers in base sides
Bedside units with storage
Bedside lights AC
Dressing table with mirror and low-back chair
Two-seater settee
Air conditioning
Halogen overhead lighting 24v
2 x table lamps
4 x large vertical portholes with blinds each side (opening portholes with mosquito screens)
Double AC sockets
2 x telephone points (dressing table and standard bedside table)
LCD flatscreen television (42")
DVD/CD/Radio entertainment system with two speakers and sub-woofer
Door to en suite toilet/shower room and walk-in wardrobe
Fitted carpet
Double berth
Foam mattress for berth
Sensor connected to fire detection system

21 Master stateroom walk-in wardrobe

Hanging rails
Drawers
Shelves
Full-length mirror
Halogen overhead lighting 24v
Fitted carpet
Door to stateroom

22 Master stateroom en suite

Granite vanity top and flooring
Tecma toilet 24v
Bidet
Twin washbasins with hot and cold water
Taps and accessories (toothbrush and glass holder, soap dish, towel rails and towels)
Large shower
Extractor fan
Air conditioning outlet
Mirrors
Halogen overhead lighting 24v
Opening porthole with mosquito screen and Venetian blind
Shaver socket 240/110v
Door to stateroom

23 Crew mess

Access door from stern
Storage
Sink
Air conditioning
AC sockets
Extract fan
Microwave
Sofa and table
LCD flatscreen television (20")
DVD/CD player with two speakers
Door to crew cabins and toilet/shower
Non-slip flooring
Engine room access door
Halogen overhead lighting 24v
Sensor connected to fire detection system
Small fridge
Washer/Dryer AC
Telephone socket
Opening porthole with mosquito screen and venetian blind

24 Crew toilet/shower

Washbasin
Shower with door
Mirror on bulkhead
Halogen overhead lighting 24v
Shaver socket 240/110v
Extractor fan
Door to crew area
Tecma toilet 24v

25 Aft starboard crew cabin

Twin bunk berths with foam mattresses
Air conditioning
Halogen overhead lighting 24v
Double AC socket
Reading light 24v
Fitted carpet
Door to crew mess
Sensor connected to fire detection system
Telephone point (outboard shelf)
Opening porthole with mosquito screen and curtains

26 Forward starboard crew cabin

Twin bunk berths with foam mattresses
Air conditioning
Halogen overhead lighting 24v
Double AC socket
Reading light 24v
Fitted carpet
Door to crew mess
Sensor connected to fire detection system
Telephone point (outboard shelf)
Opening porthole with mosquito screen and curtains

27 Engine compartment and ancillaries

Separate fuel filters with water alarms
Automatic fire extinguisher with engine/generator and fan shutdown
1 x automatic bilge pump (in each watertight compartment)
1 x automatic flood pump (in each watertight compartment)
2 x extractor fans AC
Manual bilge pump
24v socket
Sensor connected to fire detection system
Lighting (AC and DC)

28 Electrical system

Euro Specification only: 2 x 23kw slow speed Kohler generators with underwater silent exhaust
Euro Specification only: 2 x 28kw slow speed Kohler generators with underwater silent exhaust
Euro Specification only: Dockside AC connection sockets x 2 (2 x 63 amp)
USA Specification only: Dockside AC connection 1 x 100 amp Glendinning cablemaster
24v and 12v DC electrical system with full circuit breaker protection
4 x engine batteries 24v circuit
8 x domestic batteries 24v circuit
2 x generator batteries 12v circuit
Alternator split charging system
Remote battery switches controlled from locker in cockpit
2 X 95amp battery chargers for 24v circuit
1 X 20amp battery charger for 12v circuit
2 x 2kw immersion heaters for calorifier
AC sockets throughout the boat
Fire detection system with monitoring panel in Wheelhouse

29 Underwater gear

5-blade NAB bronze propellers
Bronze P-brackets
Stainless steel Temet 25 shafts
Dripless shaft logs with spare seals
High-performance bronze rudders and struts
Seawater strainers x 2 main engines and generators
Seacocks on all underwater fittings
Full cathodic bonding system to zinc anodes
Hydraulic bow thruster (30hp)
Hydraulic stern thruster (30hp)
Hydraulic trim tabs
Antifouling

30 Systems

Hydraulic power steering on gearbox
Tecma toilets (24v) with control (incorporating tank level indication)
Toilets discharging overboard or to black water tank
Black waste water tank (454 litres/120 US gal.) discharging to dockside or overboard (24v) macerator pump
Washbasins, showers, air conditioning fan units discharging to grey waste sump
Grey waste water sump with overboard discharge (24v)
Fresh water tank with electric sending unit
AC fresh water pump
Hot water circulating pump
2 X 150 litre calorifiers, each with 2 x 2kw immersion heaters
Chilled water air conditioning system (reverse cycle)

31 Miscellaneous

Toolkit
Boat hook
6 x mooring ropes
8 x fenders
Vacuum cleaner
Spare bulbs and fuses
1 set of towels per person

FLYBRIDGE

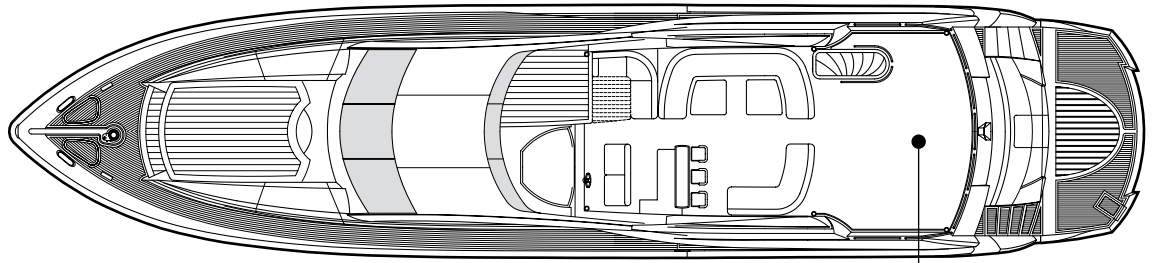

Optional spa tub and crane

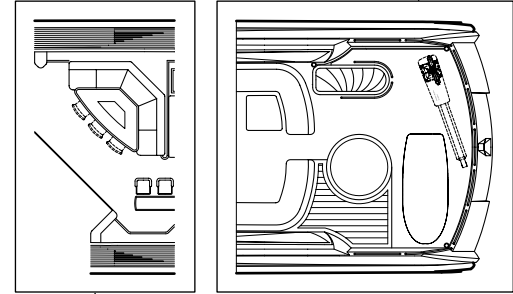

Optional built in dining

MAIN DECK

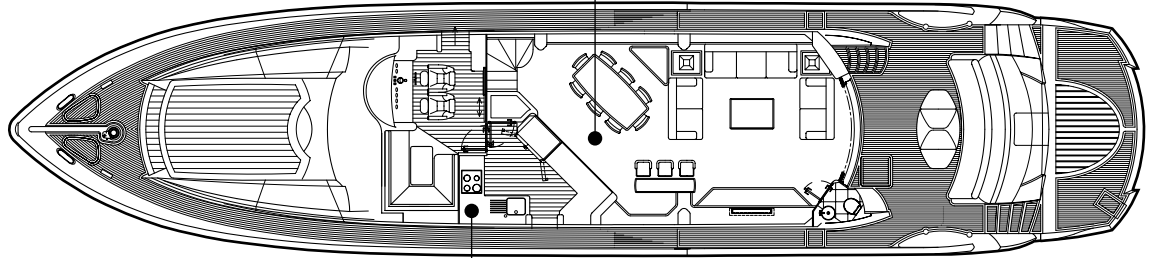

Optional extended galley

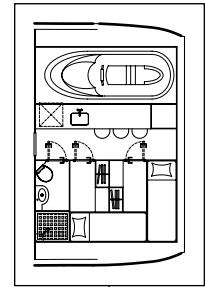
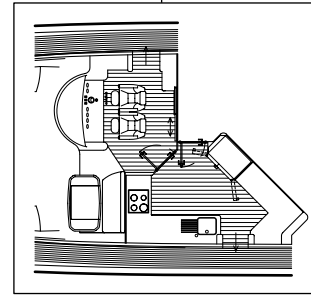

Optional crew/garage

LOWER DECK

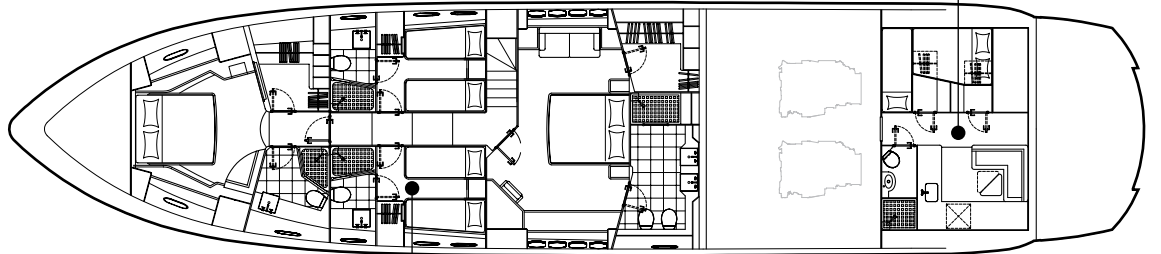

Optional twin guest to double

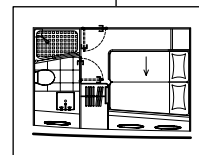





THE WORLD'S FINEST LUXURY MOTORYACHTS

*Every attempt has been made to give accurate information, but performance and range figures are estimates given as a guide only. Dirt or growth on the hull, tuning of the engines, size, make of engines fitted, damage to propellers, the temperature of the air and water, the weight of fuel, water, stores, number of people, propeller pitch, quality of fuel and other matters, can all affect a boat's performance and range. For these and other reasons we can give no performance, range or other guarantees, and neither such guarantees nor anything contained herein constitutes an offer of contract or any representation or agreement, or may otherwise be relied upon. The photographs and artist's impressions in this brochure are of existing models in the Sunseeker range. There may be items shown in these photographs and artist's impressions that are not included in the standard inventory of the models shown. Specifications contained on the web site are samples only and should not be relied upon and may refer to models only intended for sale in a particular territory and not generally. No guarantee is given that any model will be available in any territory; however by contacting us we can advise you of models that are likely to be available in each territory. Actual specifications will be provided when a sales order or enquiry is placed with us or our approved Sunseeker dealer. Specifications for models sold in different markets may vary and specifications and models may be changed or withdrawn at any time without prior notice. The individual specification for each vessel will be agreed as part of the sale contract between the purchaser and the Sunseeker dealer. Dealers and distributors are independently owned and operated entities, and therefore Sunseeker dealers and distributors are not owned by Sunseeker International Limited or any subsidiaries or other related entity of this company nor are they their agents. Therefore they have absolutely no authority to commit Sunseeker International Limited, or any subsidiary or other related entities of Sunseeker International Limited to any pledge, contract or agreement in any form or by any means unless first accepted in writing by Sunseeker International Limited. In some examples herein Sunseeker have referred to measurements, specifications or other details applicable to a particular territory and no guarantee is given that these are applicable to your territory. For ease of reference we have, in some cases, referred to "we" or "Sunseeker" and these terms should be taken to mean Sunseeker International Limited.

Designed, written and produced by Marketing Matters Limited. Printed in England. August 2007. ©Sunseeker International.

Naval architects
Don Shead/Sunseeker Design
Exterior styling
Sunseeker Design
Interior design
Sunseeker Design
Builder
Sunseeker International

www.sunseeker.com