

# 75



## SUNSEEKER 75 YACHT

SPECIFICATION



With big boat performance, a top speed in excess of 32 knots, meticulous finishing and a range of opulent extras, this Sunseeker offers the best of everything. It accommodates eight in four en suite cabins, offers crew quarters and delivers an impressive cruising range, ensuring you reach your destination in style.

- A:** Forward VIP stateroom
- B:** Twin guest cabin
- C:** Twin guest cabin
- D:** Owner's stateroom
- E:** Main saloon
- F:** Dining area
- G:** Galley
- H:** Eye-catching in any marina





PRINCIPAL CHARACTERISTICS

Length overall – (incl. pulpit and platform)	23.13m	75'11"	
Length waterline – (@ half load)	17.85m	58'7"	
Beam – (maximum)	5.66m	18'7"	
Height above waterline – (incl. mast)	6.75m	22'2"	
Draft – (@ full load incl. props)	1.68m	5'6"	
Displacement – (@ half load)	42700kg	94137 lb	
Fuel capacity	5500 litres	1210 GB gal.	1453 US gal.
Fresh water capacity	1100 litres	242 GB gal.	291 US gal.
Propulsion	Twin FP props in tunnels		
Engine options	up to 3150 PS (total)		
Fuel options	Diesel		
Generators	Standard		
	1 x 19kW @ 50Hz (Euro)		
	1 x 23kW @ 60Hz (US)		
Maximum speed	up to 32 knots*		
Cruising speed	up to 25 knots*		
Range	up to 300 nautical miles*		

PRINCIPAL FEATURES

- Air conditioning

Hydraulic lifting platform

Electric winch with deck, cockpit and flybridge controls

Side opening helm access door

Hot and cold swimming shower

Access from saloon to flybridge

Electronic echo sounder and speedlog

Power-assisted steering

Wetbar with hot and cold water

2 x ice maker

Flatscreen televisions in all cabins

Hi-fi surround DVD/CD system and radio/CD players

Hot and cold water system

Electric refrigerator and freezer

Ceramic hob and microwave/grill/oven

Radar/Chart plotter with GPS

Autopilot

VHF radio

Trim tabs

Vacuum toilets with holding tank

Automatic fire extinguishers

Automatic bilge pumps

Slow speed generator with silent exhaust

AC shorepower/battery charger

Bow thruster

Stern thruster
- Fresh water marina connection

Teak bathing platform and steps

Teak side decks

Teak cockpit floor

Stern winches

Antifouling

All items included in standard specification.

US specification includes:

US Coast Guard build regulations

US specification appliances



SPECIFICATION

1 Construction

Hand-laid GRP  
Gel coat including stripes  
Vinylester skin coat with powderbound mat  
Stitched multi-axial reinforced single skin bottom  
Balsa cored hull topsides  
PVC foam cored deck and superstructure  
Hull stiffened with longitudinal stringers supported by transverse bulkheads and floors

2 Deck

Fittings all in stainless steel  
8 x deck cleats  
Pulpit and cockpit rails  
Stainless steel fendering with rubber insert  
Stainless steel bow roller with anchor stop  
Stainless steel bow plate  
Delta anchor and 60m chain (galvanised)  
Electric winch and capstan with deck, cockpit and flybridge controls  
Chain locker fender stowage  
Curved direct glazed safety glass windscreen  
Pantograph windscreen wipers 24v and washers  
Fuel fillers port and starboard  
Fresh water filler  
IMCO navigation lights  
Remote spotlight 24v  
Ensign staff and socket  
Fender tie bar under anchor locker lid  
6 x fenders  
4 x wraps

3 Bathing platform

Teak-laid hydraulic lifting bathing platform  
Hot and cold swimming shower  
Fresh water marina connection  
Dockside AC shore power connection  
Stainless steel swimming ladder  
Lazarette stowage for fenders

4 Flybridge helm position

Access hatch and stairs to saloon and cockpit  
Self draining  
Acrylic deflecting spray screen  
Hydraulic steering  
Duplicate engine controls and instrumentation  
Duplicate autopilot controls  
Compass  
Steering indicator  
Trim tab control  
Seating for 6/8  
Table  
Instrument cover  
Stainless steel guard rails and grab rails  
Glass holders  
Wetbar with hot and cold water, ice maker and ceramic griddle  
Radio/CD remote control  
Cockpit speakers  
Low-level flybridge lighting 24v  
Lights under radar arch 24v

5 Aft cockpit

Teak-laid cockpit floor  
Self draining  
Stairs to flybridge  
Stern seating  
Side rope lockers  
Stern safety doors  
Engine room access hatch  
2 x stern capstan winches 24v and fairleads  
Cockpit speakers  
Overhead cockpit lights 24v  
Low-level courtesy lights in aft cockpit 24v  
Low-level courtesy lights on side decks 24v

6 Main helm console

Upholstered helm seat  
Console with walnut fascia  
Hydraulic power steering  
Wooden rimmed steering wheel  
Radar/Chart plotter/GPS/Autopilot  
Full analogue engine instrumentation  
Electronic speedlog  
Depth sounder  
Rudder indicator  
Fresh water gauge  
Fuel gauge  
VHF radio dual station  
Trim tab controls  
Cigar lighter  
Compass  
Horn  
Switch panels  
Windscreen wipers with washers  
Glass holders  
Fire extinguisher  
Side opening door to side deck  
Chart stowage

7 Saloon

Large dining area in upper saloon  
Air conditioning  
Occasional seating in lower saloon  
Plasma television  
Hi-fi/DVD/CD surround system  
Drinks cabinet  
Stainless steel sliding cockpit doors to aft cockpit  
Halogen overhead lighting 24v  
Low-level lights 24v  
Main control panel (AC/DC)  
Generator controls  
2 x double AC sockets  
Vacuum cleaner (stowed in lobby locker)  
Choice of lacquered interior finishes and veneers  
Scatter cushions

8 Galley

Electric refrigerator and freezer  
4-ring ceramic hob  
Microwave/Grill/Oven  
Stainless steel sink  
Hot and cold water  
Rubbish bin  
8 place crockery set  
8 place cutlery set  
Cupboard and drawer, stowage below  
2 x double AC sockets  
Fire extinguisher  
Hob extractor  
Dishwasher  
First aid kit

9 Master stateroom

Double berth  
Storage beneath  
Drawers in base-end  
Dressing table with mirror and stool  
Air conditioning  
Halogen overhead lights 24v  
2 x reading lights 24v  
2 x opening portholes with mosquito screens and curtains  
4 x large fixed side windows  
Double AC socket  
Flatscreen television  
Radio/CD/DVD player  
Door to en suite bathroom  
Door to en suite walk in wardrobe  
Fitted carpet

10 Master en suite shower room

Vacuum toilet  
Washbasin  
Taps and accessories  
Large shower  
Extractor fan  
Air conditioning outlet  
Mirror  
Toothbrush and glass holder  
Towel ring and towels  
Halogen overhead light 24v  
Opening porthole with mosquito screen and blind  
Shaver socket 240/110v

11 Port guest cabin

2 x single berths  
Under berth stowage  
Bedside unit with drawer  
2 x reading lights 24v  
Full hanging wardrobe  
Air conditioning  
Halogen overhead lights 24v  
Opening porthole with mosquito screen and curtains  
Double AC socket  
Overhead lockers  
Flatscreen television

12 Port toilet/shower room

Vacuum toilet  
Washbasin  
Taps and accessories  
Separate shower compartment  
Extractor fan  
Air conditioning outlet  
Mirrored vanity unit  
Shelved cupboard  
Toothbrush and glass holder  
Towel ring and towels  
Halogen overhead light 24v  
Opening porthole with mosquito screen and blind  
Shaver socket 240/110v

13 Starboard guest cabin

2 x single berths  
Under berth stowage  
Bedside unit with drawer  
2 x reading lights 24v  
Full hanging wardrobe  
Air conditioning  
Halogen overhead lights 24v  
Opening porthole with mosquito screen and curtains  
Double AC socket  
Door to en suite shower room  
Overhead lockers  
Flatscreen television

14 Starboard toilet/shower room

Vacuum toilet  
Washbasin  
Taps and accessories  
Separate shower compartment  
Extractor fan  
Air conditioning outlet  
Mirrored vanity unit  
Shelved cupboard  
Toothbrush and glassholder  
Towel ring and towels  
Halogen overhead light 24v  
Opening porthole with mosquito screen and blind  
Shaver socket 240/110v

15 Forward guest stateroom

Double berth  
Storage beneath  
Drawers in base-end  
Walk in wardrobe behind closed door  
Dressing table with stool  
Overhead lockers  
Air conditioning  
Flatscreen television  
Halogen overhead lights 24v  
2 x reading lights 24v  
2 x opening portholes with mosquito screens and curtains  
Double AC socket  
Door to en suite toilet/shower  
Fitted carpet

16 Forward en suite shower room

Vacuum toilet  
Washbasin  
Taps and accessories  
Separate shower compartment  
Air conditioning outlet  
Extractor fan  
Mirrored vanity unit  
Shelved cupboard  
Toothbrush and glass holder  
Towel ring and towels  
Halogen overhead light 24v  
Opening porthole with mosquito screen and blind  
Shaver socket 240/110v

17 Crew cabin

Entrance door from the stern  
Two berths  
Wardrobe  
Halogen overhead lighting 24v  
Reading light 24v  
AC socket  
Washbasin and shower  
Mirrored vanity unit and towel  
Opening porthole with mosquito screen  
Toilet  
Shaver point 240/110v

18 Engine compartment and ancillaries

Soundproofing throughout engine room  
Fuel tanks with electric sending unit  
Separate fuel filters/water separators  
Automatic fire extinguisher  
Engine room and forward bilge flood alarms  
2 x automatic bilge pumps  
2 x automatic flood pumps  
2 x extractor fans  
Manual bilge pump

19 Electrical system

Slow speed generator with underwater silent exhaust  
and sound box  
AC dockside connection  
Galvanic isolator  
24v and 12v DC electrical system with full circuit  
breaker protection  
8 x engine batteries 24v circuit  
4 x domestic batteries 24v circuit  
2 x generator batteries 12v circuit  
Alternator split charging system  
Remote battery switches controlled from locker in  
cockpit  
Battery charger for 24v circuits  
Battery charger for 12v circuits  
Water heater  
AC sockets throughout the boat  
24v hand light and cable

20 Underwater gear

5-blade NAB bronze propellers  
Bronze P-brackets  
Stainless steel Temet 25 shafts  
Dripless shaft logs with spare seals  
High-performance bronze rudders and struts  
Seawater strainers – 2 x main engines/  
1 x generator  
Seacocks on all underwater fittings  
Full cathodic bonding system to zinc anodes  
Hydraulic bow thruster  
Hydraulic stern thruster  
Hydraulic trim tabs 24v

21 Systems

Hydraulic power steering engine driven pump  
24v vacuum toilet system  
Toilet waste holding tank with monitoring system  
Aluminium fresh water tank with electric sending unit  
24v fresh water pressure system  
Hot water tank  
Washing machine

22 Miscellaneous

Toolkit  
Boat hook  
4 x mooring ropes  
6 x fenders  
Spare bulbs and fuses  
4 sets of towels

23 Optional extras

Flybridge crane  
Tender  
Teak deck on flybridge

US specification includes

US Coast Guard build regulations  
US specification appliances



MK1 – FLYBRIDGE

Optional teak deck and crane shown

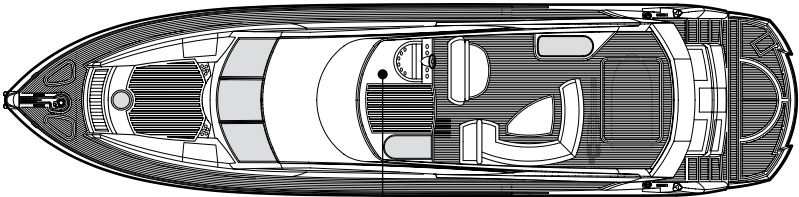

Optional large sunpad (No access hatch)

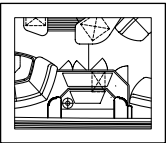
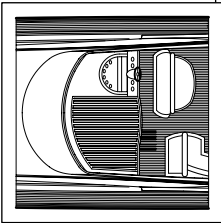

Optional bar

MK1 – MAIN DECK

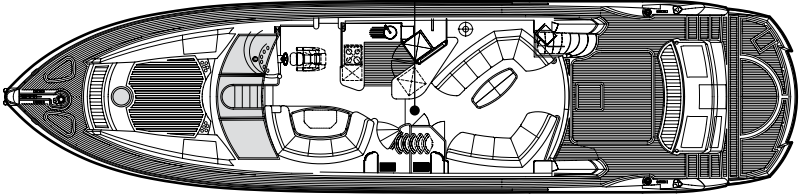

MK1 – LOWER DECK

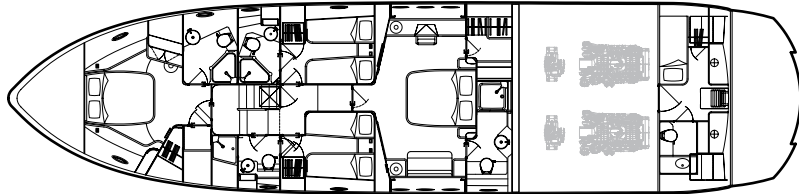

MK2 – FLYBRIDGE

Optional teak deck and crane shown

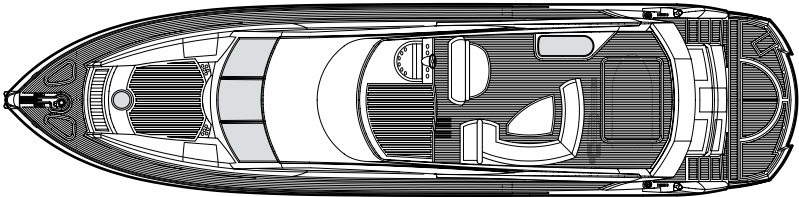

MK2 – MAIN DECK

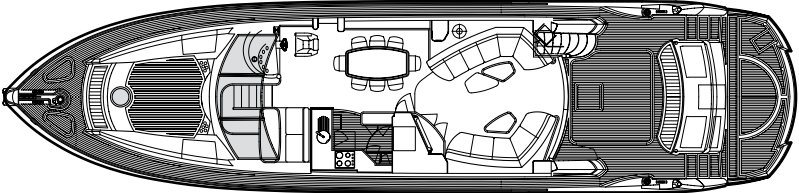

MK2 – LOWER DECK

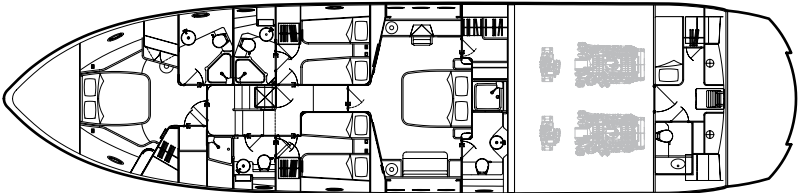







THE WORLD'S FINEST LUXURY MOTORYACHTS



Sunseeker International Limited has CE Approval which is compulsory for all boats with a LOA of 24m and below when sold in the EU.

\*Every attempt has been made to give accurate information, but performance and range figures are estimates given as a guide only. Dirt or growth on the hull, tuning of the engines, size, make of engines fitted, damage to propellers, the temperature of the air and water, the weight of fuel, water, stores, number of people, propeller pitch, quality of fuel and other matters, can all affect a boat's performance and range. For these and other reasons we can give no performance, range or other guarantees, and neither such guarantees nor anything contained herein constitutes an offer of contract or any representation or agreement, or may otherwise be relied upon. The photographs and artist's impressions in this brochure are of existing models in the Sunseeker range. There may be items shown in these photographs and artist's impressions that are not included in the standard inventory of the models shown. Specifications contained on the web site are samples only and should not be relied upon and may refer to models only intended for sale in a particular territory and not generally. No guarantee is given that any model will be available in any territory; however by contacting us we can advise you of models that are likely to be available in each territory. Actual specifications will be provided when a sales order or enquiry is placed with us or our approved Sunseeker dealer. Specifications for models sold in different markets may vary and specifications and models may be changed or withdrawn at any time without prior notice. The individual specification for each vessel will be agreed as part of the sale contract between the purchaser and the Sunseeker dealer. Dealers and distributors are independently owned and operated entities, and therefore Sunseeker dealers and distributors are not owned by Sunseeker International Limited or any subsidiaries or other related entity of this company nor are they their agents. Therefore they have absolutely no authority to commit Sunseeker International Limited, or any subsidiary or other related entities of Sunseeker International Limited to any pledge, contract or agreement in any form or by any means unless first accepted in writing by Sunseeker International Limited. In some examples herein Sunseeker have referred to measurements, specifications or other details applicable to a particular territory and no guarantee is given that these are applicable to your territory. For ease of reference we have, in some cases, referred to "we" or "Sunseeker" and these terms should be taken to mean Sunseeker International Limited.

Designed, written and produced by Marketing Matters Limited. Printed in England. August 2007. ©Sunseeker International.

**Naval architects**  
Don Shead/Sunseeker Design  
**Exterior styling**  
Sunseeker Design  
**Interior design**  
Sunseeker Design  
**Builder**  
Sunseeker International

**[www.sunseeker.com](http://www.sunseeker.com)**